

# Componentes PARA ESQUADRIAS

CATÁLOGO DE PRODUTOS  
LINHA SERRALHEIRO

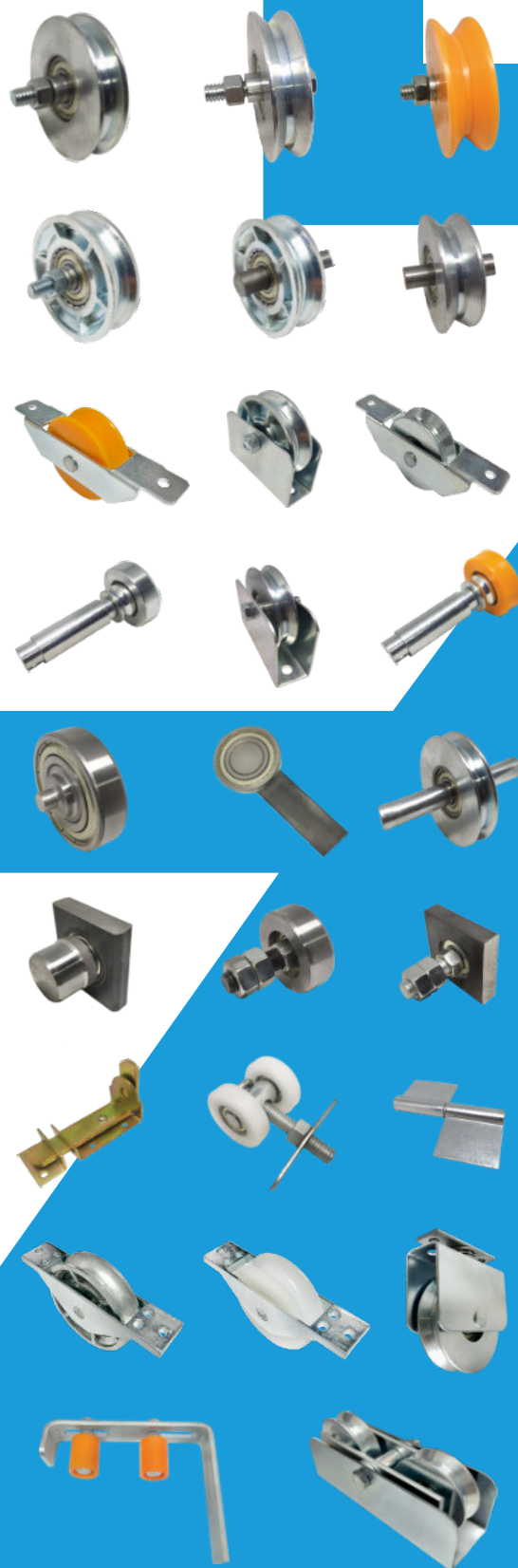

**POLETTO**<sup>®</sup>  
metalúrgica

# Segurança, qualidade e confiança!



A empresa Poletto Metalúrgica Ltda foi fundada em 2008, localizada na Serra Gaúcha, cidade de Veranópolis – RS. Especializada na fabricação de componentes para serralheria, está constantemente crescendo no mercado local e também nacional.

## MISSÃO

Nossa missão consiste na fabricação de produtos linha serralheiro, buscando sempre o melhor atendimento e satisfação, com qualidade agilidade e melhores preços de mercado, a empresa executa normas e projetos aliados a prática da melhoria contínua em todos os departamentos.

## VISÃO

Busca-se constante conhecimento tecnológico e administrativo para o aperfeiçoamento contínuo e para inovação do nosso sistema produtivo, de modo que se obtenha lucro e crescimento contínuo.

# Índice

Roldanas – Mais vendidas	04
Mancais	25
Kits para Portões	28
Rodízios e Rolamentos	30
Acessórios	35
Mais opções de Roldanas	39



# Roldanas

Roldanas V

Roldanas U

Caixas

Suportes

Roletes

Roldanas Guia

**CONFIRA NOSSO MIX  
DAS MAIS VENDIDAS**



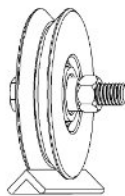

## Aço



Polida



Zincada

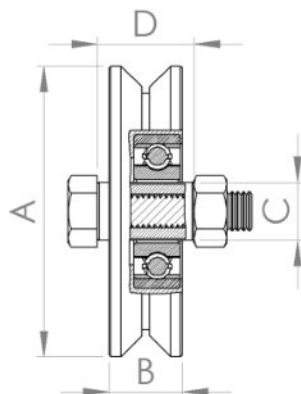

### 1 Rolamento – Estreita

Cód. Polida	Cód. Zincada	A	B	C	D	Rol.	Pa.
0339	0558	1.1/2"	16	12	25	6201	5/16"
0335	0560	2"					
0336	0561	2.1/2"					
0520	0566	70					
0337	0562	3"	17	15	25	6202	3/8"
0340	0563	80					
0451	0568	90					
0338	0565	4"					
0342	0569	5"					

### 1 Rolamento – Larga

Cód. Polida	Cód. Zincada	A	B	C	D	Rol.	Pa.	
0760	0767	2"	17	12	25	6201	5/16"	
0761	0768	2.1/2"						
0872	0971	70	19	15		6202		3/8"
0762	0769	3"						
0763	0341	80						
0764	0972	90	17	15	25	6202	3/8"	
0765	0770	4"						
0766	0771	5"						

### 2 Rolamentos

Cód. Polida	Cód. Zincada	A	B	C	D	Rol.	Pa.	
0327	0959	2"	24	12	33	6201	5/16"	
0328	0960	2.1/2"						
0895	0961	70	28	15		6202		3/8"
0329	0962	3"						
0330	0963	80						
0896	0964	90	32	20	38	6204	M12	
0331	0965	4"						
0332	0966	5"						
0333	0967	6"						

## Zamac



Polida



Zincada



Zincada Preta

### 1 Rolamento

Cód. Polida	Cód. Zincada	Cód. Zincada Preto	A	B	C	D	Rol.	Pa.	
1820	1854	1858	2"	16	12	25	6201	5/16"	
1851	1855	1859	2.1/2"						
1852	1856	1860	3"	18	15		6202		3/8"
1853	1857	1861	4"						

## Nylon



Nylon Raiada



Nylon Lisa

### 1 Rolamento – Nylon Lisa

Cód.	A	B	C	D	Rol.	Pa.	
0071	2"	20	12	25	6001	5/16"	
0291	2.1/2"				6201		
0881	70		15		6202		3/8"
0292	3"						
0882	80						
0884	90						
0293	4"						

### 1 Rolamento – Nylon Raiada

Cód.	A	B	C	D	Rol.	Pa.
1020	2.1/2"	18	12	25	6201	3/8"
1021	3"		15		6202	
1022	4"					

Pino

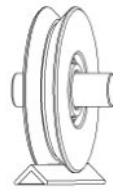

## Roldana V

Aço

## 1 Rolamento - Estreita

Cód. Polida	Cód. Zincada	A	B	C	D	Rol.
0019	0528	1.1/2"	16	12	45	6001
0017	0551	2"				6201
0027	0552	2.1/2"		15		6202
0893	0555	70				
0018	0553	3"				
0073	0554	80				
0493	0557	90				
0099	0556	4"	17	6203		
0344	0559	5"				

## 1 Rolamento - Larga

Cód. Polida	Cód. Zincada	A	B	C	D	Rol.
0746	0753	2"	17	12	45	6201
0747	0754	2.1/2"	19			15
0894	0970	70				
0748	0755	3"				
0749	0756	80				
0750	0757	90				
0751	0758	4"	17	6203		
0752	0759	5"				

## 2 Rolamentos

Cód. Polida	Cód. Zincada	A	B	C	D	Rol.	
0053	0950	2"	24	12	60	6201	
0047	0951	2.1/2"				28	15
0518	0952	70					
0042	0953	3"					
0334	0954	80					
0521	0955	90	17	6203			
0016	0956	4"					
0074	0957	5"	32	20	100	6204	
0075	0958	6"					

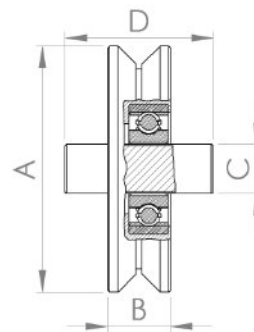

Polida



Zincada

Zamac

## 1 Rolamento

Cód. Polida	Cód. Zincada	Cód. Zincada Preto	A	B	C	D	Rol.
1868	1872	1876	2"	16	12	45	6201
1869	1873	1877	2.1/2"				18
1870	1874	1878	3"				
1871	1875	1879	4"				



Polida



Zincada

Nylon

## 1 Rolamento

Cód.	A	B	C	D	Rol.
0973	2"	20	12	45	6001
0974	2.1/2"				6201
0975	70		15		6202
0976	3"				
0977	80				
0978	90				
0979	4"				



Zincada Preta

# Roldana V



## Aço



Polida



Zincada

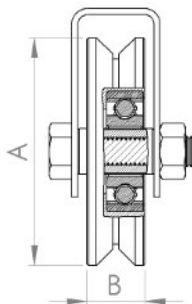

### 1 Rolamento - Estreita

Cód. Polida	Cód. Zincada	A	B	Rol.	Pa.
0345	0537	1.1/2"	16	6001	5/16"
0347	0538	2"		6201	
0348	0539	2.1/2"		6202	3/8"
0939	0940	70			
0349	0540	3"			
0350	0541	80			
0351	0542	90			
0353	0543	4"			

### 1 Rolamento - Larga

Cód. Polida	Cód. Zincada	A	B	Rol.	Pa.
0941	0511	2"	17	6201	5/16"
0942	0512	2.1/2"	19		
0943	0513	70			
0944	0514	3"			
0945	0515	80			
0947	0516	90			
0949	0517	4"			

### 2 Rolamentos

Cód. Polida	Cód. Zincada	A	B	Rol.	Pa.
0356	0545	2"	24	6201	5/16
0357	0546	2.1/2"			
0354	0544	70	28	6202	3/8"
0360	0547	3"			
0363	0548	80			
0364	0549	90			
0365	0550	4"			

## Zamac



Zincada

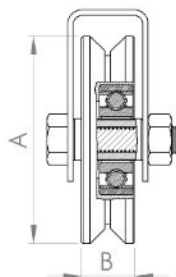

### 1 Rolamento

Cód.	A	B	Rol.	Pa.
1958	2"	16	6201	5/16"
1959	2.1/2"			
1960	3"	18	6202	3/8"
1961	4"			

## Nylon

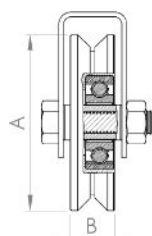

Chapas Laterais e Parafusos

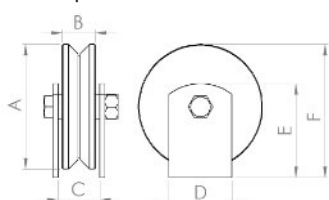

### 1 Rolamento

Cód.	A	B	Rol.	Pa.
0050	2"	17	6001	5/16"
0065	2.1/2"		6201	
0064	70	20	6202	3/8"
0066	3"			
0981	80			
0982	90			
0068	4"			

### 1 Rolamento

Cód.	A	B	C	D	E	F
0696	2"	20	25	1.1/2"	42,5	57,5
0697	2.1/2"				50	71,5
0698	3"				56,5	80
0699	4"				69	105



# Caixa Fechada

## Rebitada

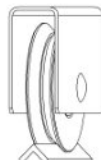

# Roldana V

Aço

### 1 Rolamento - Estreita

Cód. Polida	Cód. Zincada	A	B	Rol.	Rebite
1078	1086	1.1/2"	16	6001	5/16"
1079	1087	2"		6201	
1080	1088	2.1/2"			
1081	1089	70		6202	3/8"
1082	1090	3"			
1083	1091	80			
1084	1092	90			
1085	1093	4"			

### 1 Rolamento - Larga

Cód. Polida	Cód. Zincada	A	B	Rol.	Rebite
1094	1101	2"	17	6201	5/16"
1095	1102	2.1/2"	19		
1096	1103	70		6202	3/8"
1097	1104	3"			
1098	1105	80			
1099	1106	90			
1100	1107	4"			

### 2 Rolamentos

Cód. Polida	Cód. Zincada	A	B	Rol.	Rebite
1108	1115	2"	24	6201	5/16"
1109	1116	2.1/2"			
1110	1117	70			
1111	1118	3"	28	6202	3/8"
1112	1119	80			
1113	1120	90			
1114	1121	4"			

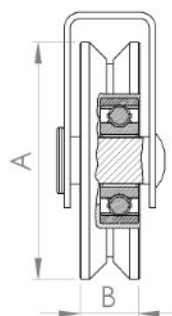

Polida



Zincada

Zamac

### 1 Rolamento

Cód.	A	B	Rol.	Rebite
1962	2"	16	6201	5/16"
1963	2.1/2"			
1964	3"	18	6202	3/8"
1965	4"			

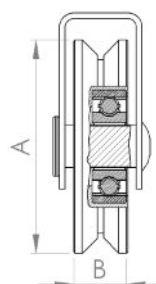

Zincada

Nylon

### 1 Rolamento

Cód.	A	B	Rol.	Rebite
0983	2"	17	6001	5/16"
0984	2.1/2"		6201	
0985	70	20	6202	3/8"
0986	3"			
0987	80			
0988	90			
0989	4"			

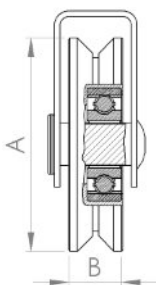

# Roldana V

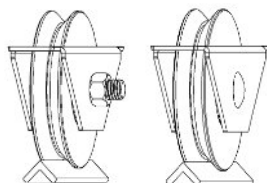

**Caixa Aberta**

## Aço



Rebite

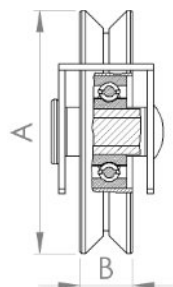

### 1 rolamento - Estreita

Cód. Cx. Rebitada Zincada	Cód. Cx. Parafuso Zincada	A	B	Rol.	Pa. Rebite
0664	1019	1.1/2"	16	6001	5/16"
0646	1008	2"			
0647	1009	2.1/2"		6201	
0648	1132	3"			
0649	1133	4"			6202



Parafuso

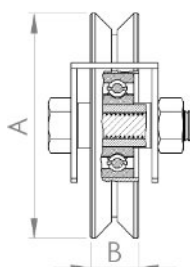

### 1 rolamento - Larga

Cód. Cx. Rebitada Zincada	Cód. Cx. Parafuso Zincada	A	B	Rol.	Pa. Rebite
1134	1137	2.1/2"	19	6201	5/16"
1135	1138	3"		6202	3/8"
1136	1139	4"			

## Zamac - Caixa Aço



Rebite



Parafuso

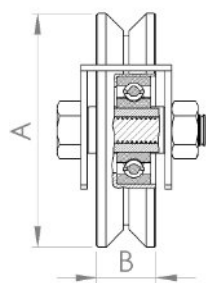

### 1 rolamento

Cód. cx rebitada zincada	Cód cx parafuso zincada	A	B	Rol.	Pa. Rebite
1914	1910	2"	16	6201	5/16"
1915	1911	2.1/2"			
1916	1912	3"	18	6202	3/8"
1917	1913	4"			

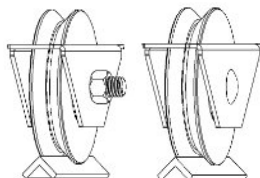

Zamac - Caixa Zamac

1 rolamento

Cód. Cx. zincada	A	B	Rol.	Rebite
1982	2"	16	6201	5/16"
1983	2.1/2"	18		
1984	70mm		6202	3/8"

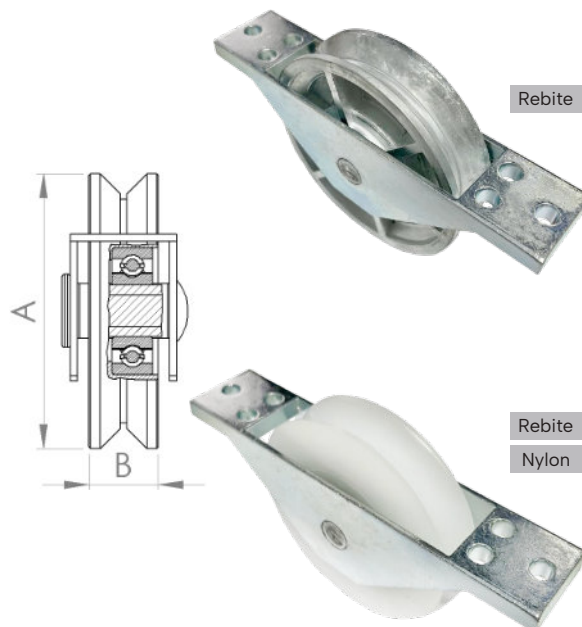

1 rolamento

Cód. Cx. Zincada	A	B	Rol.	Rebite
1991	2"	17	6201	5/16"
1992	2.1/2"	20		
1993	70mm		6202	3/8"

Nylon

1 rolamento

Cód. Cx. Rebitada	Cód. Cx. Parafuso	A	B	Rol.	Pa. Rebite
0660	0999	2"	17	6001	5/16"
0661	1000	2.1/2"	20	6201	
0662	1130	3"		6202	3/8"
0663	1131	4"			

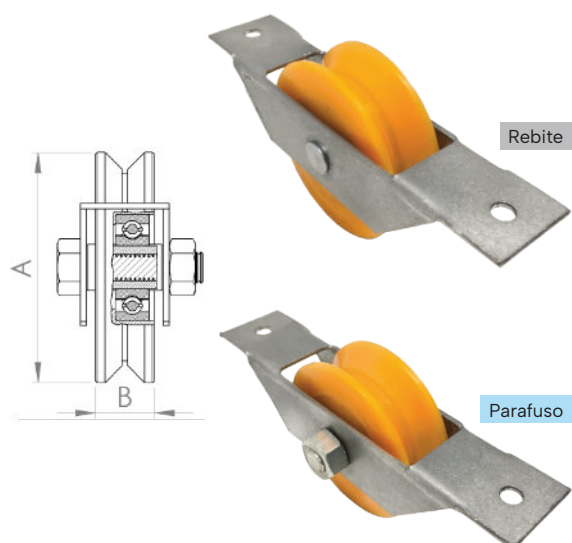

# Roldana V

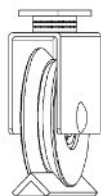

## Giratória



Zincada

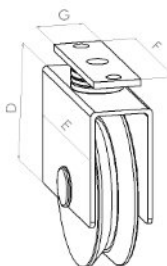
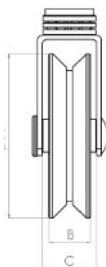

### 1 rolamento

Cód. Zincada	A	B	C	D	E	F	G	Rol.
1821	2"	18	25	38	50	50	7/8"	6201
1822	2.1/2"			50	72	70		
1823	3"			55	85			122
1824	4"			75				

# Roldana V

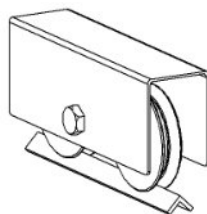

## Truck



Zincada  
1 Rolamento



Zincada  
2 Rolamentos

### 1 Rolamento

Cód. Zincada	A	B	C	D	E	Rol.
0921	2.1/2"	18	165	60	50	6201
0922	3"		195	70		6202
0923	4"		235	85		

### 2 Rolamentos

Cód. Zincada	A	B	C	D	E	Rol.
0924	2.1/2"	24	165	60	50	6201
0925	3"	28	195	70		6202
0926	4"	28	235	85		

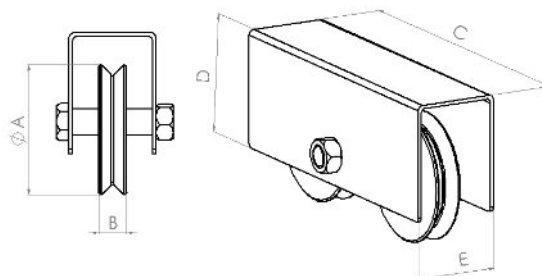

# Caixa Fechada

Aço – para Roldana polida e zincada

### 1 Rolamento

Cód. Caixa Polida	Cód. Caixa Zincada	A	B	C
0728	0653	50	29	2"
0729	0654	56		2.1/2"
0730	0655	62		3"
0731	0656	62		80
0732	0657	74		90
0733	0658	74		4"

### 2 Rolamentos

Cód. Caixa Polida	Cód. Caixa Zincada	A	B	C
0734	0740	50	32	2"
0735	0741	56		2.1/2"
0736	0742	62		3"
0737	0743	62		80
0738	0744	74		90
0739	0745	74		4"

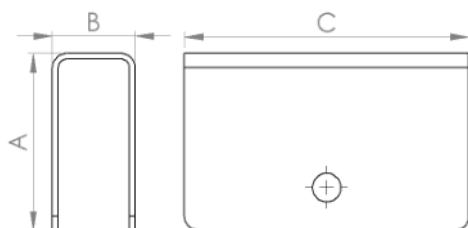

Polida



Zincada

## Suporte

Caixa aberta

Cód.	A	B	C
0530	20	29	1.1/2"
0531			2"
0532	30		2.1/2"
0533	40		3"
0534	50		4"

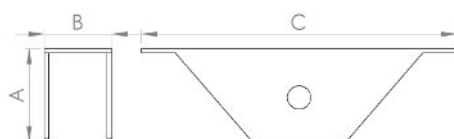

Zincada

# Roldana U

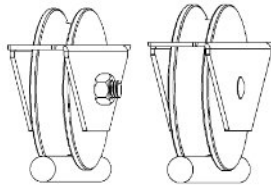

Ferro 1/2"

Caixa aberta

## Aço

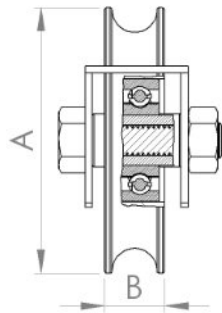

1 rolamento

Cód. cx rebitada zincada	Cód cx parafuso zincada	A	B	RoL.	Pa. rebite
1140	1144	1.1/2"	16	6001	5/16"
0652	1145	2"	17		
1141	1146	2.1/2"	19	6201	3/8"
1142	1147	3"		6202	
1143	1148	4"			

## Zamac - Caixa Aço

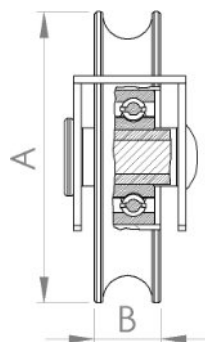

1 rolamento

Cód. cx rebitada zincada	Cód cx parafuso zincada	A	B	RoL.	Pa. rebite
1922	1918	2"	16	6201	5/16"
1923	1919	2.1/2"	18		
1924	1920	3"		6202	3/8"
1925	1921	4"			

**Ferro 1/2"**  
Caixa aberta

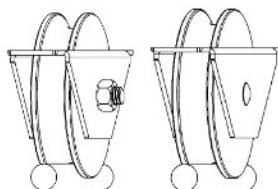

Zamac - Caixa Zamac

1 rolamento

Cód. zincada Rebite	A	B	Rol.	Rebite
1985	2"	16	6201	5/16"
1986	2.1/2"	18		
1987	70mm			6202

1 rolamento

Cód. zincada Rebite + Nylon	A	B	Rol.	Rebite
1994	2.1/2"	20	6201	5/16"
1995	70mm		6202	3/8"

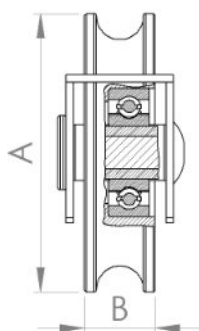

Nylon

1 rolamento

Cód. cx rebitada	Cód cx c/ parafuso	A	B	Rol.	Pa. rebite
1159	1163	2"	20	6001	5/16"
1160	1164	2.1/2"		6201	
1161	1165	3"		6202	3/8"
1162	1166	4"			

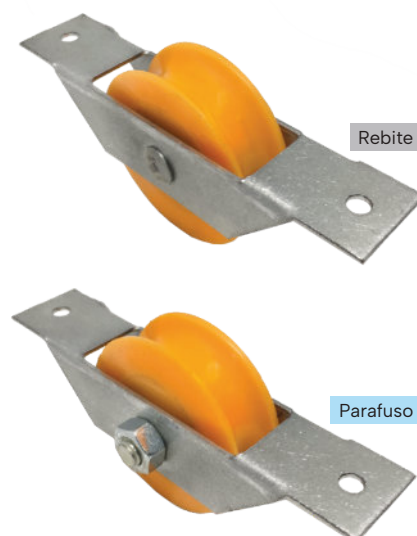
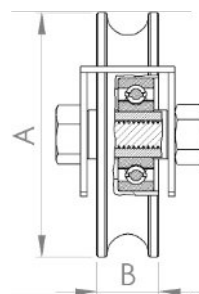

# Roldana U

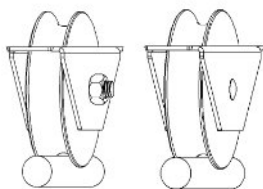

**Ferro 5/8"**

 Caixa aberta

## Aço



Rebite



Parafuso

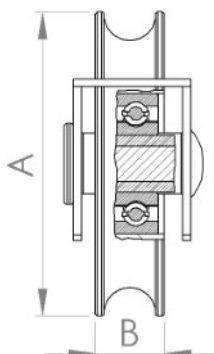

⊙ 1 rolamento

Cód. cx rebitada zincada	Cód cx parafuso zincada	A	B	Rol.	Pa. rebite
1149	1154	1.1/2"	17	6001	5/16"
1150	1155	2"	19		
1151	1156	2.1/2"		6201	
1152	1157	3"		6202	3/8"
1153	1158	4"			

## Zamac - Caixa Aço



Rebite



Parafuso

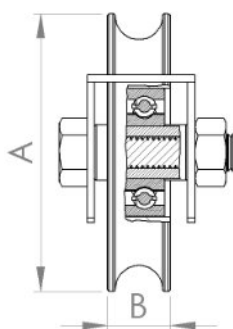

⊙ 1 rolamento

Cód. cx rebitada zincada	Cód cx parafuso zincada	A	B	Rol.	Pa. rebite
1930	1926	2"	18	6201	5/16"
1931	1927	2.1/2"			
1932	1928	3"	6202	3/8"	
1933	1929	4"			



**Ferro 5/8"**  
Caixa aberta

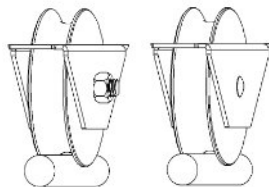

Zamac - Caixa Zamac

1 rolamento

Cód. zincada Rebite	A	B	Rol.	Rebite
1988	2"	18	6201	5/16"
1989	2.1/2"			
1990	3"		6202	3/8"

1 rolamento

Cód. zincada Rebite + Nylon	A	B	Rol.	Rebite
1996	2.1/2"	20	6201	5/16"
1997	3"		6202	3/8"

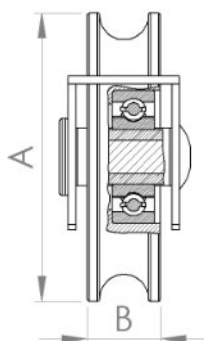

Rebite



Rebite

Nylon

Nylon

1 rolamento

Cód. cx rebitada	Cód cx c/ parafuso	A	B	Rol.	Pa. rebite
1167	1171	2"	20	6001	5/16"
1168	1172	2.1/2"		6201	
1169	1173	3"		6202	3/8"
1170	1174	4"			

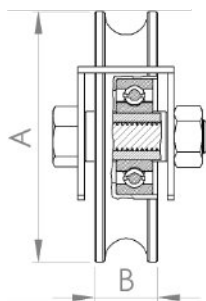

Rebite

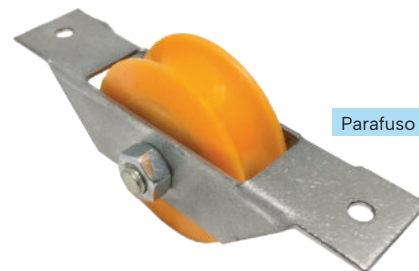

Parafuso

# Roletes

## Rolete Superior

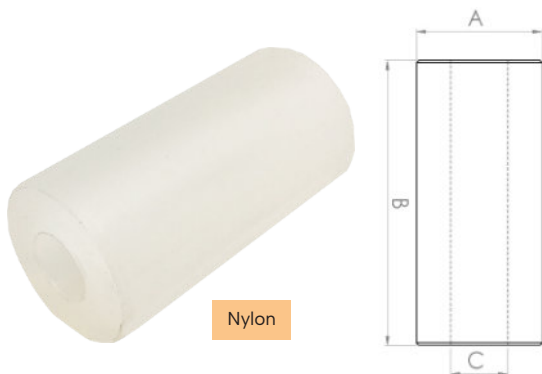

Nylon

### 22mm – furo central 10mm

Cód.	A	B	C
1004	22	50	10
1005		60	
1006		75	

### 25mm – furo central 13mm

Cód.	A	B	C
0716	25	50	13
0717		60	
0718		70	
0719		80	
0720		90	
0721		100	

### 25mm – furo central 10mm

Cód.	A	B	C
0710	25	50	10
0711		60	
0712		70	
0713		80	
0714		90	
0715		100	

### 38mm – furo central 13mm

Cód.	A	B	C
0722	38	60	13
0723		70	
0724		80	
0725		90	
0726		100	
0727		120	

## Rolete Superior Portão de Correr

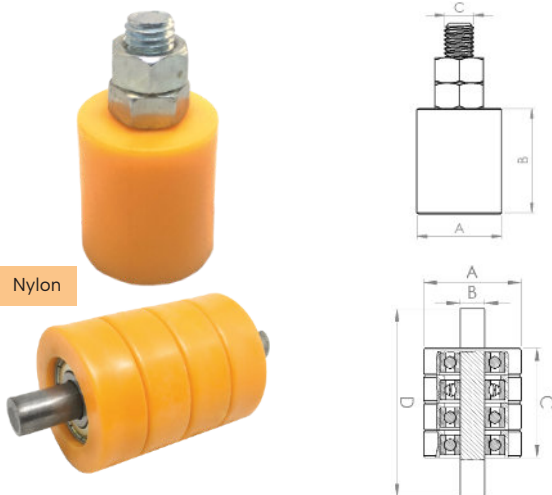

Nylon

### Sem rolamento

Cód.	A	B	C
0709	28.5	35	3/8"

### Com rolamento

Cód.	A	B	C	D	Rol.
1029	48	12	54	85	3 peças 6201
1030			72	105	4 peças 6201
1031			90	120	5 peças 6201
1032			36	70	2 peças 6201
1033			108	140	6 peças 6201
1034			144	175	8 peças 6201
1035			126	160	7 peças 6201

# Guias Portão de Correr

## 2 Roletes

Regulagem de 35 a 85mm entre roletes

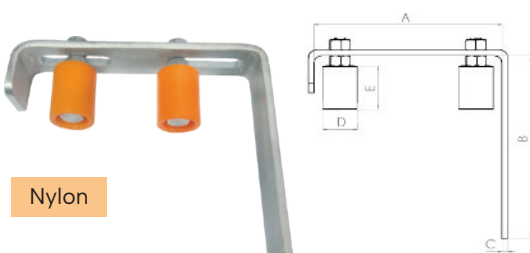

Nylon

Cód.	A	B	C	D	E
0092	152	148	4,5	28	35

## 2 Roletes e Regulagem Lateral

Regulagem de 35 a 85mm entre roletes



Cód.	A	B	C	D	E
0914	152	210	4,5	28	35

# Roldana Guia

Portão de Correr

Cód.	A	B	C	D	E	F
0062	3"	16	5/8"	94	4	15
0013					5	
0033					7	
0012	4"				5	
0032					7	

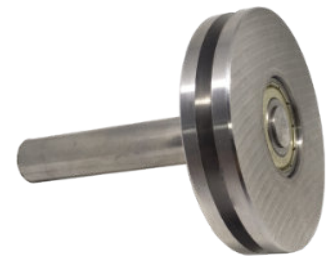
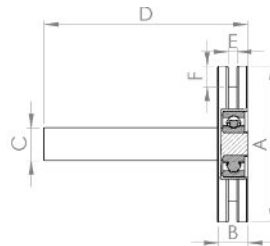

# Haste fixa

Caixa 8X10

Cód. Polida	Cód. Zincada	A	B	C	D	E	F
0090	1040	2"	32	3/16"	340	25	38
0147	1041	2.1/2"					
0148	1042	3"					
0149	1043	80					
0150	1044	4"					

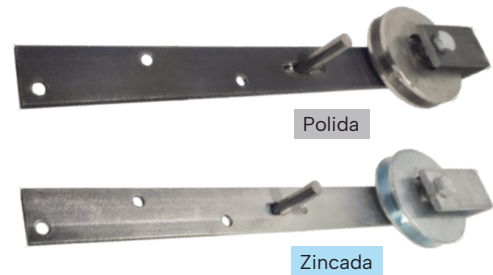
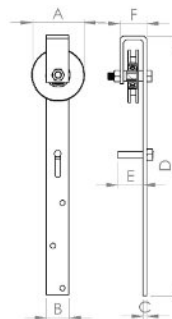

# Roldana Giratória

Suspensa Cava Quadrada 8 mm

Cód. Zincada	A	B	C	D	Rol.
1015	2"	18	8	6	6201
1016	2.1/2"				
1017	3"				
1018	4"				

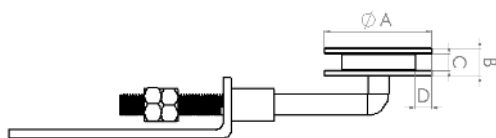

# Roldana U

Com suporte L (portão elevação) Para cabo de aço

☉ 1 rolamento

Cód. polida	Cód. zincada	A	B	C	D	Pa.	Rol.
1122	1126	2.1/2"	15	12	25	5/16"	6201
1123	1127	3"					
1124	1128	80					
1125	1129	4"				3/8"	6202

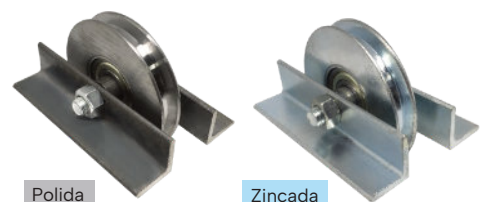
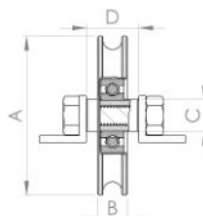

# Roldana U

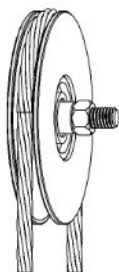

Para cabo de aço

Parafuso - Portão Elevação

## Aço



Polida



Zincada

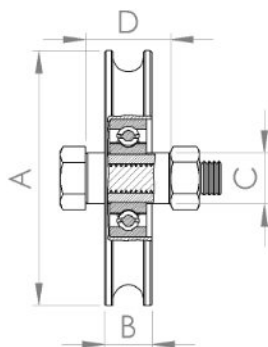

### 1 rolamento

Cód. polida	Cód. zincada	A	B	C	D	Pa.	Rol.
0171	0580	2	14	12	25	5/16"	6201
0172	0581	2.1/2"					
0873	0948	70	15	17	25	3/8"	6202
0173	0582	3"					
0182	0583	80	17	20	25	3/8"	6203
0186	0564	90					
0181	0584	4"	15	17	25	3/8"	6204
0174	0585						
0175	0586	5"	17	20	25	M12	6204
0176	0587						
0177	0588						

## Zamac



Polida



Zincada

### 1 rolamento

Cód. Polida	Cód. Zincada	Cód. Zincada preta	A	B	C	D	Rol.	Paraf.
1862	1864	1866	3"	18	15	25	6202	3/8"
1863	1865	1867	4"	15				



Zincada Preta

## Nylon



### 1 rolamento

Cód.	A	B	C	D	Pa.	Rol.
0095	2.1/2"	20	12	25	5/16"	6201
0165	3"		15		3/8"	6202
0164	80	15	15	25	3/8"	6202
0167	90					
0166	4"					

 Para cabo de aço

 Portão Elevação - Pino

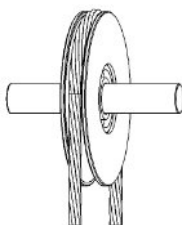

Aço

1 rolamento

Cód. polida	Cód. zincada	A	B	C	D	Rol.			
0180	0570	2"		12		6201			
0179	0571	2.1/2"							
0897	0968	70	14	15	100	6202			
0026	0572	3"							
0094	0573	80							
0093	0567	90							
0010	0574	4"	15	17		6203			
0028	0575								
0048	0576						17	20	6204
0178	0577						15	17	6203
0041	0578	5"	17	20		6204			
0067	0579	6"							

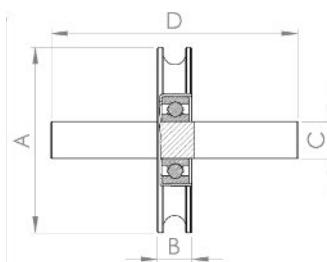

Polida



Zincada

Zamac

1 rolamento

Cód. Polida	Cód. Zincada	Cód. Zincada preta	A	B	C	D	Rol.
1880	1882	1884	3"	18	15	100	6202
1881	1883	1885	4"	15			



Polida



Zincada



Zincada Preta

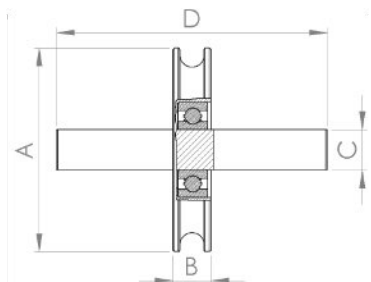

## Eixo Liso

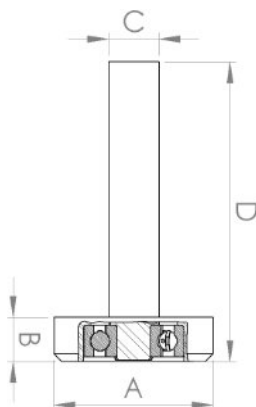

### 1 rolamento

Cód. polida	Cód. zincada	A	B	C	D	Rol.
0097	0589	47	14	5/8"	96,4	6201
0231	0590	47,5				
0035	0591	48				
0232	0592	49				
0233	0593	49,5				
0038	0594	50				
0234	0595	65				
0235	0596	68				
0236	0597	70				
0030	0598	72				
0535	0599	67	25	3/4"	120	6202
0237	0600	90				

### 1 rolamento

Cód.	A	B	C	D	Rol.
0206	47	15,5	5,8"	96,4	6201
0208	48				
0213	68				
0215	72m				

## Cava no Eixo

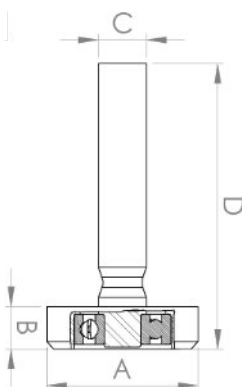

### 1 rolamento

Cód. polida	Cód. zincada	A	B	C	D	Rol.				
0096	0601	47	14	5/8"	96,4	6201				
0224	0602	47,5								
0025	0603	48								
0225	0604	49								
0226	0605	49,5								
0037	0606	50								
0227	0607	65								
0228	0608	68								
0229	0609	70								
0009	0610	72								
0230	0611	90					25	3/4"	120	6202

### 1 rolamento

Cód.	A	B	C	D	Rol.
0195	47	15,5	5/8"	96,4	6201
0197	48				
0202	68				
0204	72				

Anel no eixo

1 rolamento

Cód. polida	Cód. zincada	A	B	C	D	Rol.
0098	0612	47	14	5/8"	96,4	6201
0217	0613	47,5				
0036	0614	48				
0218	0615	49				
0219	0616	49,5				
0039	0617	50				
0220	0618	65				
0221	0619	68				
0222	0620	70				
0031	0621	72				
0223	0622	90				
0046	0623	72	3/4"	120		

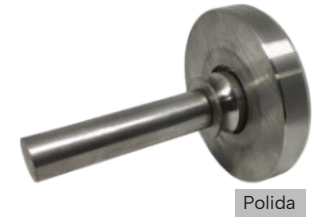
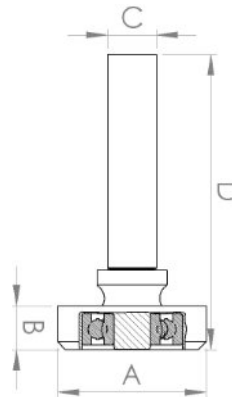

Polida



Zincada



Nylon

1 rolamento

Cód.	A	B	C	D	Rol.
0183	47	15,5	5/8"	96,4	6201
0185	48				
0190	68				
0191	70				
0192	72				
0193	72				

Tubo no eixo e anel

1 rolamento

Cód. zincada	Cód. nylon	A	B	C	D	E	F
1070	1073	44	16	15	120	3/4"	70
1071	1074	48					
1072	1075	46					
1077	1076	63					

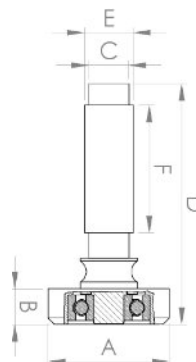

Zincada

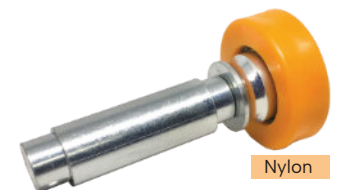

Nylon

Tubo no eixo e cava

1 rolamento

Cód.	A	B	C	D	E	F	Rol.
194	47	15,5	15	96	3/4"	50	6201

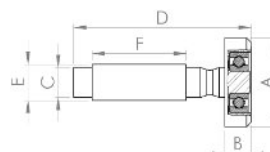

Nylon

# Roldana Superior

## Parafuso

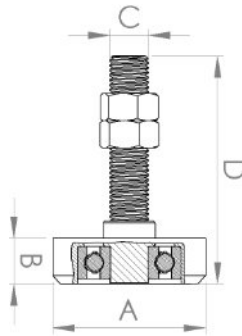

### 1 rolamento

Cód. aço zincada	Cód. nylon	A	B	C	D
1003	1001	35	16	1/2"	85
1007	1002	40			
1068	1064	42			
1069	1065	44			
1067	1066	48	18		120
1013	1014				

## Eixo

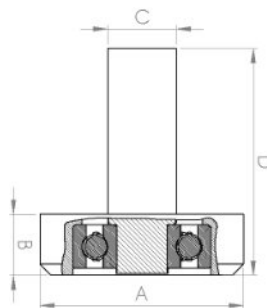

### 1 rolamento

Cód.	A	B	C	D
1054	44	16	15	70
1055		19		
1056	62	16		
1057	66			

### 1 rolamento

Cód.	A	B	C	D
0665	42	14	15	70
1058	43			
1061	66	19		
1059	44			
1060	62			
1062	66			
1063	93			

## Bucha

### Para Pino Lateral Porta Basculante

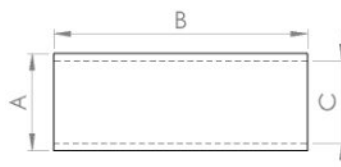

Cód.	A	B	C
0899	7/8"	30	16
0900		40	
0901		50	



# Mancais

Redondos  
Quadrados  
Retangulares  
Parafusos



# Redondos

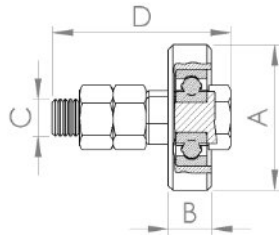

⊙ 1 rolamento - Porta basculante

Cód.	A	B	C	D
0156	47	15	M12	2"

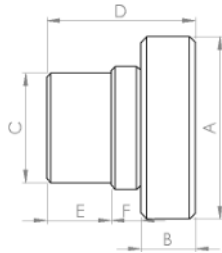

⊙ 1 rolamento - Estabilizador porta basculante

Cód.	A	B	C	D	E	F
0158	47	14	28,4	37	16	8

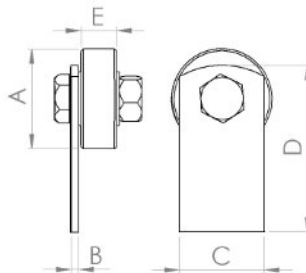

⊙ 1 rolamento - 1 haste - Inferior

Cód.	A	B	C	D	E
0990	45	3,35	1.1/2"	75	16

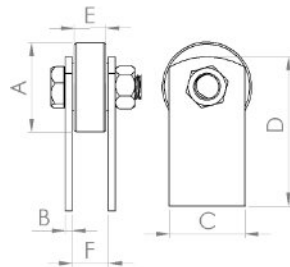

⊙ 1 rolamento - 2 hastes - Superior

Cód.	A	B	C	D	E	F
0991	45	3,35	1.1/2"	75	16	18

# Parafuso Redondo

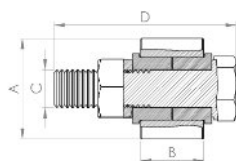

Braço porta basculante

Cód.	A	B	C	D
0043	32	20	M12	2"

# Quadrados

## 1 rolamento - Porta basculante

Cód.	A	B	C	D	E
1012	2"	2"	5/8"	2"	M12
0007			1/2"		
0785	1.1/2"	1.1/2"			

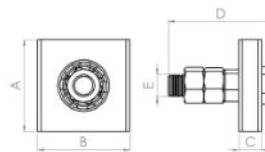

## 1 rolamento - Estabilizador porta basculante

Cód.	A	B	C	D	E	F	G
0029	2"	2"	1/2"	37	28.4	16	8
0008					21.8		

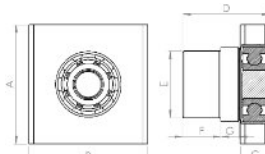

# Retangulares

## 1 rolamento - Porta basculante

Cód.	A	B	C	D	E
0155	70	2"	5/8"	2"	M12
1010	65		1/2"		

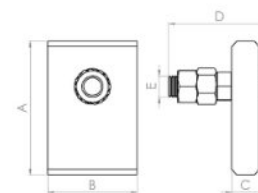

## 1 rolamento - Porta basculante (cantos arredondados)

Cód.	A	B	C	D	E
0789	74	2"	5/8"	2"	M12
1011	65		1/2"		

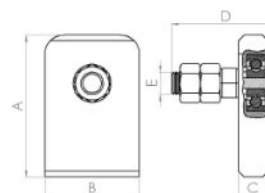

# Parafuso Ferro Chato

## Braço porta basculante

Cód.	A	B	C	D
0044	15.8	10.3	M12	40

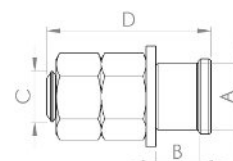

# Kits para Portão

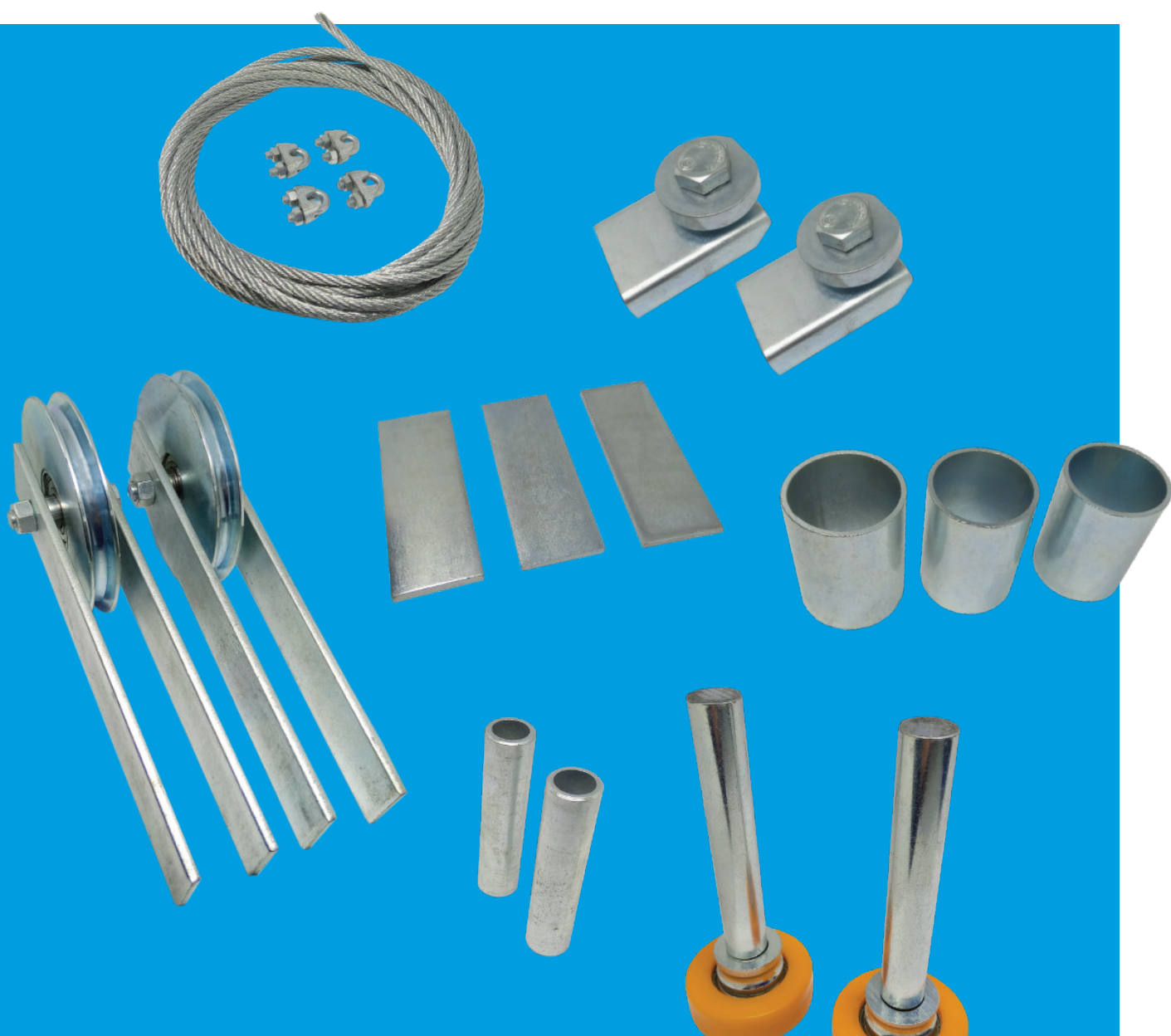

## Kit 01

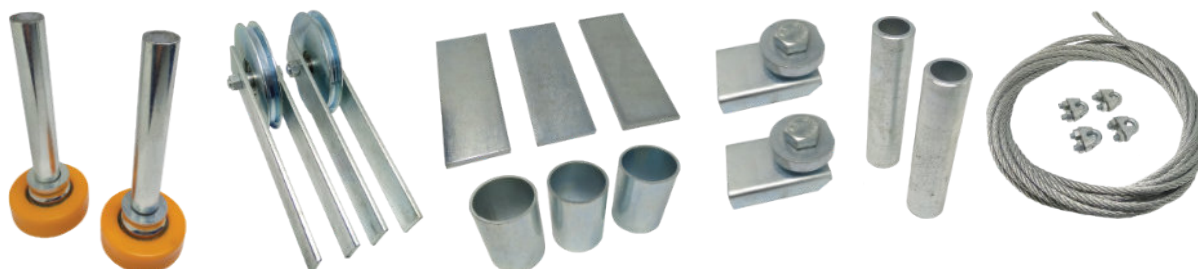

### Caixa 120mm

Cód.	A	B	C	D	E	F	G	H
0294	3"	48	60	37	4,5m	1.1/4"	80	200

### Caixa 150mm

Cód.	A	B	C	D	E	F	G	H
0295	4"	48	60	37	4,5m	1.1/4"	80	200

### Caixa 180mm

Cód.	A	B	C	D	E	F	G	H
0296	5"	48	60	37	4,5m	1.1/4"	80	200

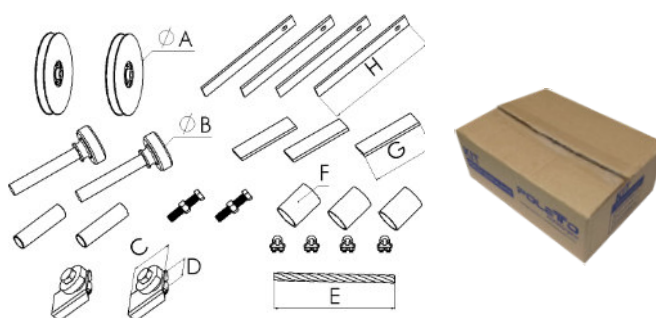

## Kit 02



### Caixa 120mm

Cód.	A	B	C	D	E
0690	80	48	54	200	4,5m
0693		60			

### Caixa 150mm

Cód.	A	B	C	D	E
0691	4"	48	54	200	4,5m
0694		60			

### Caixa 180mm

Cód.	A	B	C	D	E
0692	5"	48	54	200	4,5m
0695		60			

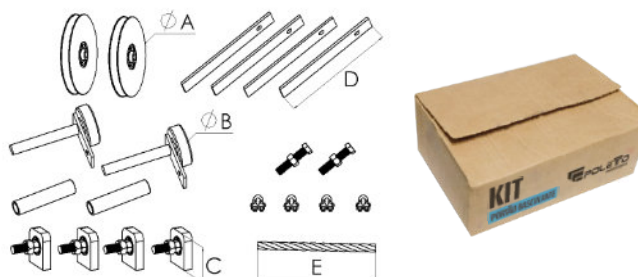

# Rodízios e Rolamentos

Rodízios Quádruplos  
Rodízios Duplos  
Rodízios Simples  
Rolamentos Haste  
Rolamentos Pino

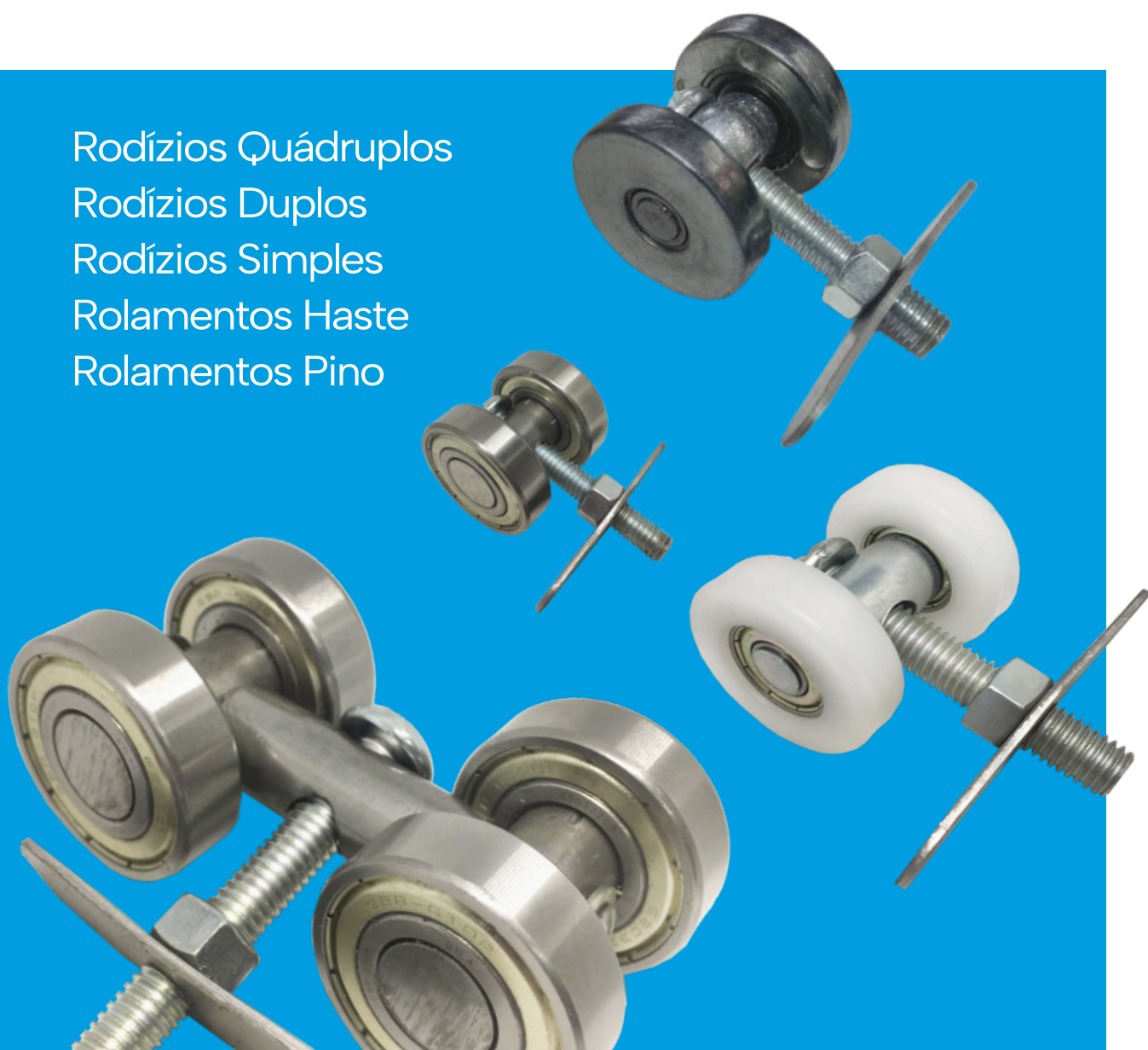

# Rodízios Simples

☐ Haste    ⚙️ Regulagem

🕒 1 rolamento

Cód nylon	Cód. torneado	Rol.	A	B	C	D	E
0145	0120	608	1.1/4"	22	2,65	9,5	60
0146	0121		1.1/2"				65



Torneado



Nylon

☐ Haste    ○ Fixo

🕒 1 rolamento

Cód nylon	Cód. torneado	Rol.	A	B	C	D	E
0069	0418	608	1.1/4"	22	2,65	9,5	60
0070	0419		1.1/2"				62

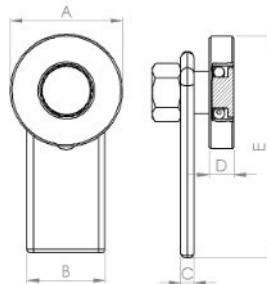

Torneado

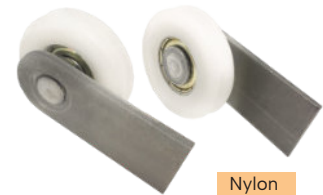

Nylon

☐ Pino

🕒 1 rolamento - 1"

Cód nylon	A	B	C	D	E
0488	1"	7	5	6,5	5

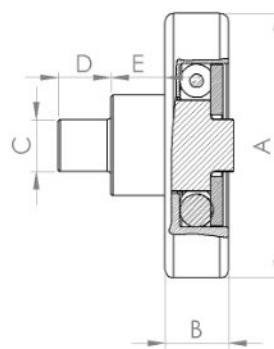

Nylon



Aço

🕒 1 rolamento - 1.1/4 e 1.1/2"

Cód.	Rol.	A	B	C	D	E
1809	608	1.1/4"	9,5	5	7	5
1810		1.1/2"				

# Rolamentos

## Pino

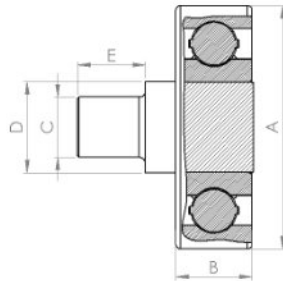

### ⊙ 1 rolamento

Cód.	Rol.	A	B	C	D	E
0439	6201	32	10	7,7	12	8,5
0440	6202	35	11		15	
0441	6203	40	14		17	
0442	6206	62	16	9,7	30	8
0509	6204	47	14	7,7	20	9,5
0659	6000	26	8	5	8	7



Nylon



Nylon

### ⊙ 1 rolamento

Cód.	Rol.	A	B	C	D	E
0137	608	32	10	5	12	7
0138		38				
0139	6201	63	16	8		8,9

## Haste



Polido

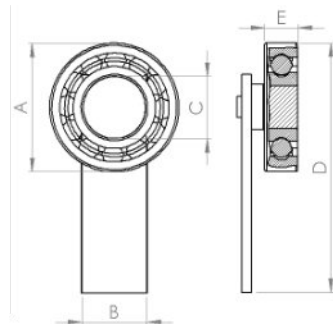

### ⊙ 1 rolamento

Cód.	Rol.	A	B	C	D	E
0142	6203	40	3/4"	17	100	12
0143	6204	47	1.1/4"	20		14
0443	6206	62		30		16



Nylon

### ⊙ 1 rolamento

Cód.	Rol.	A	B	C	D	E
0144	6201	47	1.1/4"	12	100	16
0651		63				



☉☉ 2 Rolamentos (1 em cada roda)

Cód.	Rol.	A	B	C	D	E	F	G	H
0111	6203	40	15,5	3/8"	17	12	71,5	45	73
0119	6202	35			15	11			71
0034	6001	28	19,05	5/16"	12	8	45,0	25	69

☉☉ 2 Rolamentos (1 em cada roda)

Cód.	A	B	C	D	E	F	G	H
0127	1.1/2"	15,5	3/8"	8	9,5	71,5	41	72
0913	1"		5/16"					

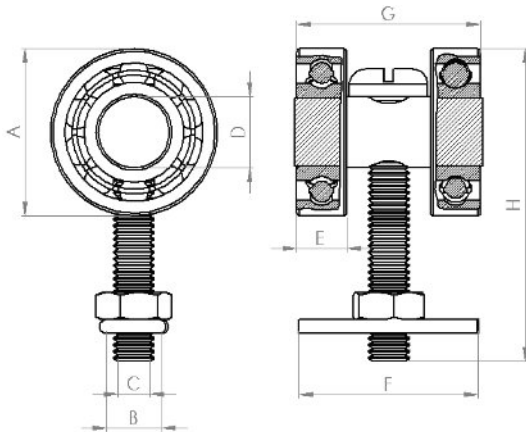

☉☉ 2 Rolamentos (1 em cada roda) + Aço Torneado

Cód. polido	Cód. zincado	A	B	C	D	E	F	G	H
0116	0123	1.1/2"	15,5	3/8"	8	9,5	71,5	41	72



Nylon



Polido



Zincado

3" portão de correr suspenso (reforçado)

☉☉ 2 Rolamentos (1 em cada roda)

Cód.	A	B	C	D	E	F	G	H	I	J	L
0784	74	15,5	17	77	5/16"	75	1/4"	2.1/2"	148	2"	94

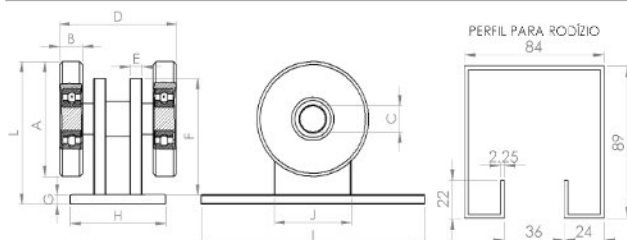



⊙⊙⊙⊙ 4 Rolamentos (1 em cada roda)

Cód.	Rol.	A	B	C	D	E	F	G	H	I
0134	6203	40	17	92	3/8"	15,5	71,5	12	73	45
0135	6202	35	15	90				11	71	



Nylon

⊙⊙⊙⊙ 4 Rolamentos (1 em cada roda)

Cód.	Rol.	A	B	C	D	E	F	G	H	I
0136	608	1.1/2"	8	91	3/8"	15,5	71,5	9,5	71	41
1219		1"			5/16"					23



Polido

⊙⊙⊙⊙ 4 Rolamentos (1 em cada roda) + Aço Torneado

Cód. polido	Cód. zincado	Rol.	A	B	C	D	E	F	G	H	I
0140	1024	608	1.1/2"	8	90	3/8"	15,5	71,5	9,5	71	41



Zincado

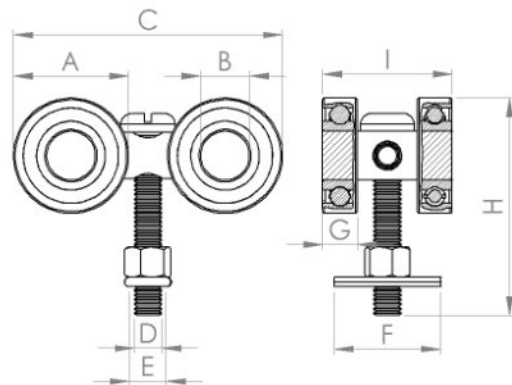

Nylon

⊙⊙⊙⊙ 4 Rolamentos (1 em cada roda) + Nylon + Argola

Cód.	A	B	C	D	E	F	G	H	I	J
0141	1.1/2"	8	91	6	3/8"	26	9,5	115	41	38

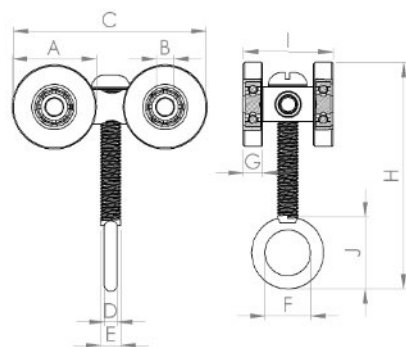

# Acessórios

Pinos  
Trancas  
Dobradiças  
Consoles  
Tampas  
Eixos



# Pinos

## Cilíndrico Duplo

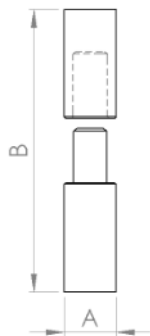

Cód. Polido	Cód. Zincado	A	B
0001	0772	3/8"	50
0002	0773	1/2"	55
0003	0774	5/8"	70
0004	0775	3/4"	80
0005	0776	7/8"	100
0006	0777	1"	120
0040	0778	1.1/4"	
0638	0639	1.1/2"	

## Cilíndrico Duplo com graxeira

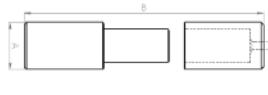
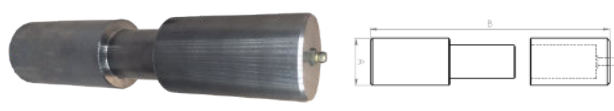

Cód.	A	B
0502	1"	120
0536	2"	170

## Cilíndrico Triplo

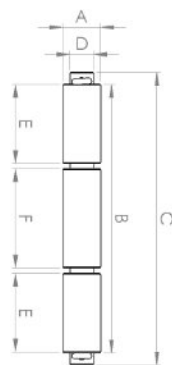

Cód. Polido	Cód. Zincado	A	B	C	D	E	F
0133	0779	5/8"	150	166	11	50	50
0014	0780	3/4"	130	147	12	40	
0015	0781	7/8"					
0063	0782	1"	150	166	14,25	50	

## Sextavado 1.1/4" X 200mm



Cód.	A	B
0100	1.1/4"	200

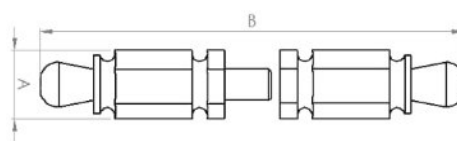

# Trancas

## Bate Fecha de Ferro

Cód. Polida	Cód. Zincada	A	B	C	D
0104	0118	75	60	44	10

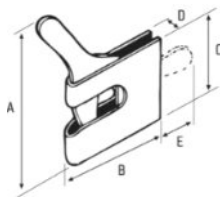

Polida

Zincada

## Fecho Chato

Cód.	A	B	C	D	E
0125	100	40	45	22,5	62
0124	120		47		90

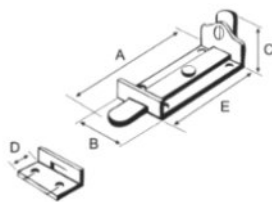

# Dobradiças e Console

## Dobradiça de Chapa

Cód. Polida	Cód. Zincada	A	B	C
0132	0131	100	15	37

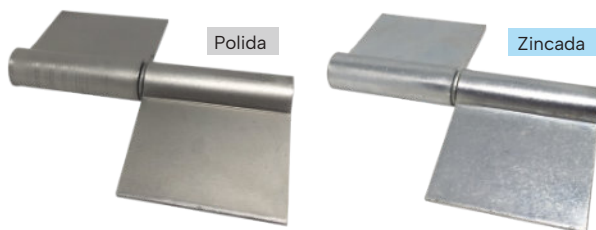
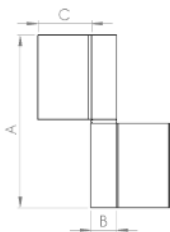

Polida

Zincada

## Dobradiça Janela Basculante

Cód. polida	A	B
0130	200	25

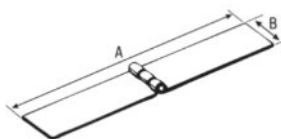

## Console Janela Basculante

Cód.	A	B	C	D
0102	33	25	16	5
0107	31	22	21	

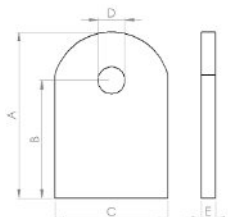

# Tampas

## Interna - Tubo quadrado e retangular



Nylon

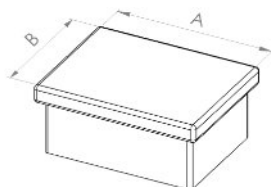

Cód.	A	B
0210	15	15
0706	20	20
0211	25	25
0212	30	20
0707		30
0290	40	20
0214		30
0216		40
0343	50	30
0401		50

## Interna - Tubo redondo



Nylon

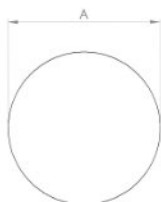

Cód.	A
0700	5/8"
0701	3/4"
0702	7/8"
0703	1"
0704	1.1/4"
0705	1.1/2"
0205	2"
0209	2.1/2"
0207	3"

## Externa - Tubo redondo



Nylon

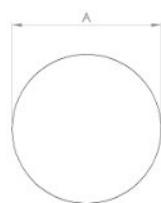

Cód.	A
0826	5/8"
0827	3/4"
0828	7/8"
0829	1"
0830	1.1/4"

# Eixo da Roldana

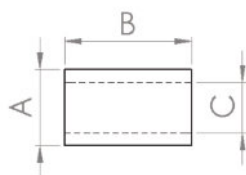

Cód.	A	B	C
0936	12	25	8
0937	15		10
0938	17		

# Mais opções de Roldanas

U Ferro  
U Tubo  
V Suporte Encaixado  
U Suporte Encaixado  
Lisas  
Cava Quadrada  
Para Academia  
Para Varal  
Porta de Correr



# Roldana U

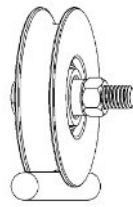

## Ferro 1/2"

Parafuso

### Aço



Polida



Zincada

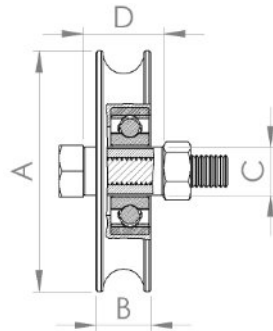

#### 1 rolamento

Cód. Polida	Cód. Zincada	A	B	C	D	Rol.	Pa.
0011	0642	1.1/2"	16	12	25	6001	5/16"
0317	0644	2"					
0318	0645	2.1/2"					
0640	0786	70	17	15	6202	3/8"	
0319	0787	3"					
0320	0788	80					
0641	0790	90					
0321	0791	4"					

#### 2 rolamentos

Cód. Polida	Cód. Zincada	A	B	C	D	Rol.	Pa.
1298	1301	1.1/2"	24	12	33	6001	5/16"
0273	1302	2"					
0274	1303	2.1/2"					
1299	1304	70	28	15	6202	3/8"	
0275	1305	3"					
0276	1306	80					
1300	1307	90					
0277	1308	4"		17			

### Zamac



Polida



Zincada

#### 1 rolamento

Cód. Polida	Cód. Zincada	Cód. Zincada Preta	A	B	C	D	Rol.	Pa.
1886	1890	1894	2"	16	12	25	6201	5/16"
1887	1891	1895	2.1/2"					
1888	1892	1896	3"	18	15	6202	3/8"	
1889	1893	1897	4"					

### Nylon



Zincada Preta



#### 1 rolamento

Cód.	A	B	C	D	Rol.	Pa.
0874	2"	20	12	25	6201	5/16"
0875	2.1/2"					
0876	70					
0992	3"	15	6202	3/8"		
0877	80					
0878	90					
0879	4"					



## Ferro 1/2"

 Pino

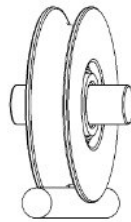

Aço

⊙ 1 rolamento

Cód. Polida	Cód. Zincada	A	B	C	D	Rol.
0404	0422	1.1/2"	16	12	45	6001
0061	0431	2"				6201
0323	0446	2.1/2"	17	15		6202
0420	0497	70				
0324	0507	3"				
0325	0508	80				
0421	0510	90				
0326	0527	4"				

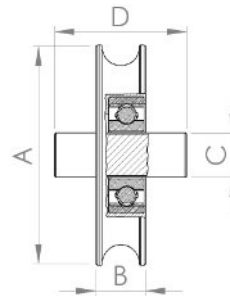

Polida



Zincada

⊙ ⊙ 2 rolamentos

Cód. Polida	Cód. Zincada	A	B	C	D	Rol.
1287	1290	1.1/2"	24	12	60	6001
0322	1291	2"				6201
0278	1292	2.1/2"	28	15		6202
1288	1293	70				
0279	1294	3"				
0280	1295	80				
1289	1296	90				
0281	1297	4"	17	6203		

Zamac

⊙ 1 rolamento

Cód. Polida	Cód. Zincada	Cód. Zincada Preta	A	B	C	D	Rol.
1898	1902	1906	2"	16	12	25	6201
1899	1903	1907	2.1/2"				18
1900	1904	1908	3"				
1901	1905	1909	4"				



Polida



Zincada



Zincada Preta

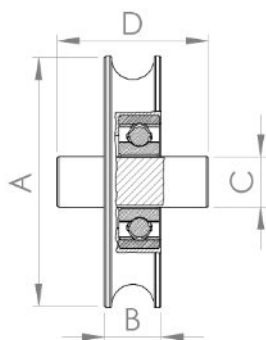

# Roldana U

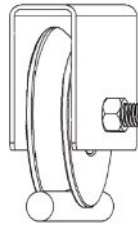

**Ferro 1/2"**

Caixa Fechada

Parafuso

## Aço

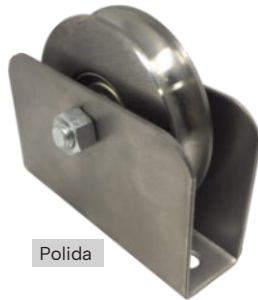

Polida



Zincada

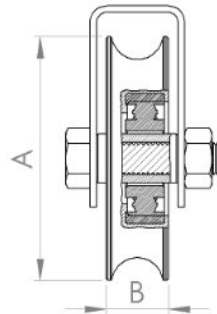

### 1 rolamento

Cód. Polida	Cód. Zincada	A	B	Rol.	Parafuso	
0808	0816	1.1/2"	16	6001	5/16"	
0809	0817	2"	17	6201		
0810	0818	2.1/2"		6202		3/8"
0811	0819	70	28	6203		
0812	0820	3"			6202	
0813	0821	80				
0814	0822	90				
0815	0823	4"				

### 2 rolamentos

Cód. Polida	Cód. Zincada	A	B	Rol.	Parafuso	
1325	1333	1.1/2"	24	6001	5/16"	
1326	1334	2"		6201		
1327	1335	2.1/2"		28	6202	3/8"
1328	1336	70				
1329	1337	3"				
1330	1338	80				
1331	1339	90				
1332	1340	4"	6203			

## Zamac

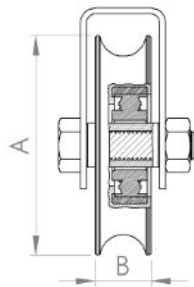

### 1 Rolamento

Cód. Parafuso	A	B	Rol.	Parafuso
1966	2"	16	6201	5/16"
1967	2.1/2"	18		
1968	3"		6202	3/8"
1969	4"			

## Nylon

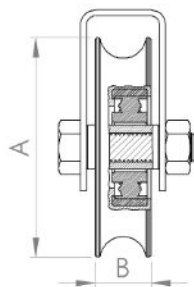

### 1 Rolamento

Cód. Parafuso	A	B	Rol.	Parafuso
1228	2"	20	6201	5/16"
1229	2.1/2"			
1230	70		6202	3/8"
1231	3"			
1232	80			
1233	90			
1234	4"			

Ferro 1/2"

Caixa Fechada

Rebitada

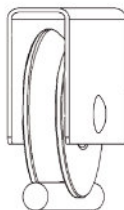

Aço

1 rolamento

Cód. Polida	Cód. Zincada	A	B	Rol.	Rebite
0792	0800	1.1/2"	16	6001	5/16"
0793	0801	2"	17	6201	
0794	0802	2.1/2"		6202	
0795	0803	70	17	6202	3/8"
0796	0804	3"			
0797	0805	80			
0798	0806	90			
0799	0807	4"			

2 rolamentos

Cód. Polida	Cód. Zincada	A	B	Rol.	Rebite
1309	1317	1.1/2"	24	6001	5/16"
1310	1318	2"		6201	
1311	1319	2.1/2"		6202	
1312	1320	70	28	6202	3/8"
1313	1321	3"			
1314	1322	80			
1315	1323	90			
1316	1324	4"			

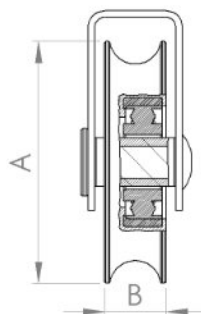

Polida



Zincada

Zamac

1 Rolamento

Cód. Zincada	A	B	Rol.	Rebite
1970	2"	16	6201	5/16"
1971	2.1/2"	18		
1972	3"		6202	3/8"
1973	4"		6201	

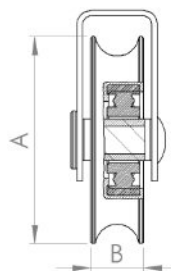

Nylon

1 Rolamento

Cód. Rebitada	A	B	Rol.	Rebite
1221	2"	20	6201	5/16"
1222	2.1/2"			
1223	70			
1224	3"	20	6202	3/8"
1225	80			
1226	90			
1227	4"			

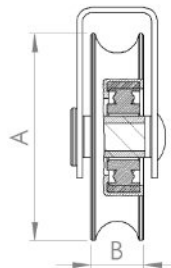

# Roldana U

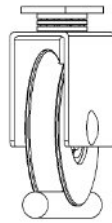

## Ferro 1/2" Giratória

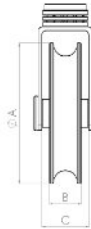

### 1 Rolamento

Cód. Zincada	A	B	C	D	E	F	G	Rol.
1825	2"	18	25	38	50	50	7/8"	6201
1826	2.1/2"			50	72	70		
1827	3"			55	85			6202
1828	4"			75	122			

# Roldana U

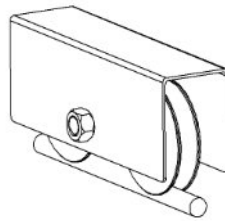

## Ferro 1/2" Truck



Zincada  
1 Rolamento

### 1 Rolamento

Cód. Zincada	A	B	C	D	E	Rol.
0927	2.1/2"	18	165	60	50	6201
0928	3"		195	70		6202
0929	4"		235	85		



Zincada  
2 Rolamentos

### 2 Rolamentos

Cód. Zincada	A	B	C	D	E	Rol.
0930	2.1/2"	24	165	60	50	6201
0931	3"	28	195	70		6202
0932	4"	28	235	85		

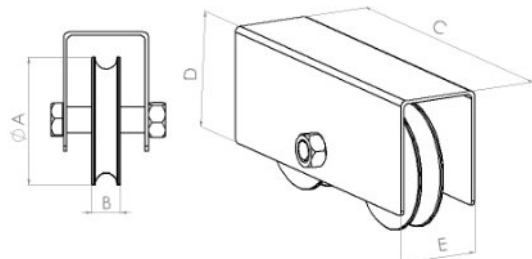

# Ferro 5/8"

Parafuso

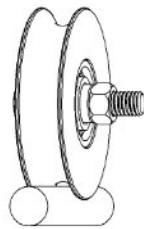

Mais Roldanas

# Roldana U

Aço

1 rolamento

Cód. Polida	Cód. Zincada	A	B	C	D	Rol.	Pa.
0840	0843	1.1/2"	19	12	25	6001	5/16"
0310	0844	2"				6201	
0311	0845	2.1/2"		6202		3/8"	
0841	0846	70					
0312	0847	3"	15	15	6202	3/8"	
0313	0848	80					
0842	0849	90		4"			
0314	0850	4"					

2 rolamentos

Cód. Polida	Cód. Zincada	A	B	C	D	Rol.	Pa.
1354	1358	1.1/2"	24	12	33	6001	5/16"
0264	1359	2"				6201	
0265	1360	2.1/2"				6202	3/8"
1355	1361	70					
0266	1362	3"	28	15	33	6202	3/8"
0267	1363	80					
1356	1364	90		17		6203	
0268	1365	4"					
0269	1366	5"	32	20	38	6204	M12
1357	1367	6"					

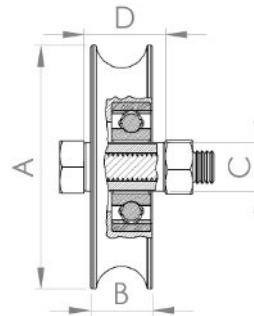

Zamac

1 rolamento

Cód. Polida	Cód. Zincada	Cód. Zincada Preta	A	B	C	D	Rol.	Pa.
1934	1938	1942	2"	18	12	25	6201	5/16"
1935	1939	1943	2.1/2"					
1936	1940	1944	3"					
1937	1941	1945	4"					



Nylon

1 rolamento

Cód.	A	B	C	D	Rol.	Pa.
0666	2"	20	12	25	6201	5/16"
0667	2.1/2"					
0993	70		15		6202	3/8"
0668	3"					
0994	80	4"				
0995	90					
0669	4"					



# Roldana U

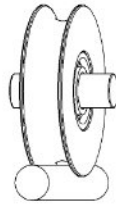

Ferro 5/8"

 Pino

## Aço



Polida



Zincada

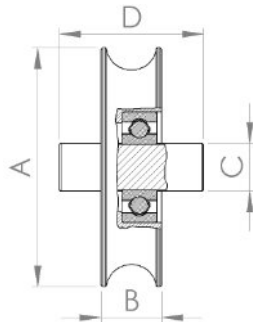

### 1 rolamento

Cód. Polida	Cód. Zincada	A	B	C	D	Rol.
0824	0832	1.1/2"	19	12	45	6001
0020	0833	2"				6201
0315	0834	2.1/2"				6202
0825	0835	70	19	15	45	6202
0021	0836	3"				
0316	0837	80				
0831	0838	90				
0022	0839	4"				

### 2 rolamentos

Cód. Polida	Cód. Zincada	A	B	C	D	Rol.
1341	1344	1.1/2"	24	12	60	6001
0270	1345	2"				6201
0271	1346	2.1/2"				6202
1342	1347	70	28	15	60	6202
0051	1348	3"				
0272	1349	80				
1343	1350	90				
0054	1351	4"				
0076	1352	5"	32	20	100	6204
0447	1353	6"				

## Zamac



Polida



Zincada



Zincada Preta

### 1 rolamento

Cód. Polida	Cód. Zincada	Cód. Zincada Preta	A	B	C	D	Rol.
1946	1950	1954	2"	18	12	25	6201
1947	1951	1955	2.1/2"				
1948	1952	1956	3"				
1949	1953	1957	4"	18	15	25	6202

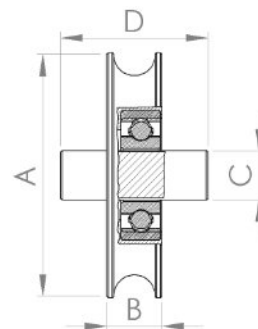

**Ferro 5/8"**  
 Caixa Fechada  
 Parafuso

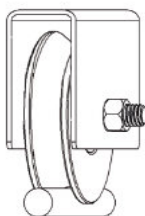

Mais Roldanas

# Roldana U

Aço

1 rolamento

Cód. Polida	Cód. Zincada	A	B	Rol.	Pa.
0867	0673	1.1/2"	19	6001	5/16"
0868	0674	2"		6201	
0869	0675	2.1/2"		6202	3/8"
0870	0676	70			
0871	0677	3"			
0670	0880	80			
0671	0678	90			
0672	0679	4"			

2 rolamentos

Cód. Polida	Cód. Zincada	A	B	Rol.	Pa.
1384	1392	1.1/2"	24	6001	5/16"
1385	1393	2"		6201	
1386	1394	2.1/2"		28	6202
1387	1395	70			
1388	1396	3"			
1389	1397	80			
1390	1398	90			
1391	1399	4"	6203		

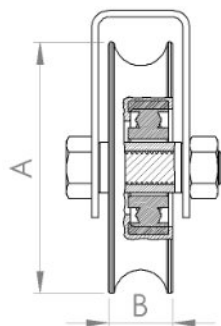

Polida



Zincada

Zamac

1 Rolamento

Cód. Parafuso	A	B	Rol.	Parafuso
1974	2"	18	6201	5/16"
1975	2.1/2"			
1976	3"		6202	3/8"
1977	4"			

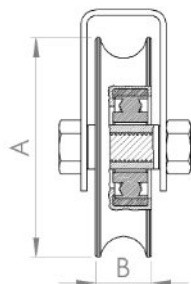

Nylon

1 Rolamento

Cód. Parafuso	A	B	Rol.	Pa. Rebite
1242	2"	20	6201	5/16"
1243	2.1/2"			
1244	70		6202	3/8"
1245	3"			
1246	80			
1247	90			
1248	4"			

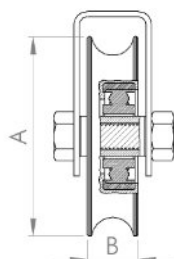

# Roldana U

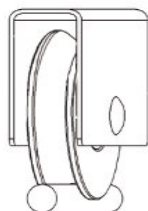

Ferro 5/8"

☐ Caixa Fechada

○ Rebitada

## Aço



Polida



Zincada

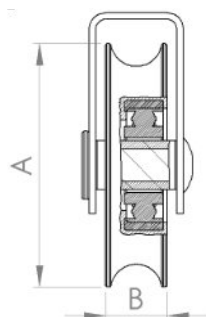

### 1 rolamento

Cód. Polida	Cód. Zincada	A	B	Rol.	Rebite
0851	0859	1.1/2"	19	6001	5/16"
0852	0860	2"		6201	
0853	0861	2.1/2"		6202	3/8"
0854	0862	70			
0855	0863	3"			
0856	0864	80			
0857	0865	90			
0858	0866	4"			

### 2 rolamentos

Cód. Polida	Cód. Zincada	A	B	Rol.	Rebite
1368	1376	1.1/2"	24	6001	5/16"
1369	1377	2"		6201	
1370	1378	2.1/2"		28	6202
1371	1379	70			
1372	1380	3"			
1373	1381	80	6203		
1374	1382	90			
1375	1383	4"			

## Zamac

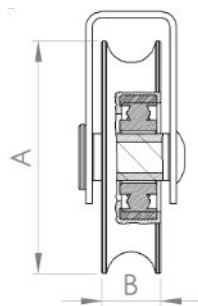

### 1 Rolamento

Cód. Zincada	A	B	Rol.	Rebite
1978	2"	18	6201	5/16"
1979	2.1/2"			
1980	3"		6202	3/8"
1981	4"			

## Nylon

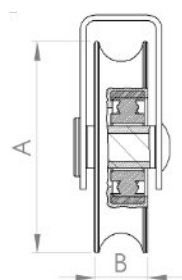

### 1 Rolamento

Cód. Rebitada	A	B	Rol.	Pa. Rebite
1235	2"	20	6201	5/16"
1236	2.1/2"			
1237	70		6202	3/8"
1238	3"			
1239	80			
1240	90			
1241	4"			



# Roldana U

## Ferro 5/8" Giratória

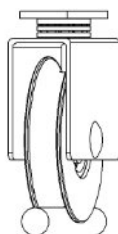

☉ 1 rolamento

Cód. Zincada	A	B	C	D	E	F	G	Rol.
1829	2"	18	25	38	50	50	7/8"	6201
1830	2.1/2"			50	72	70		
1831	3"			55	85			6202
1832	4"			75	122			

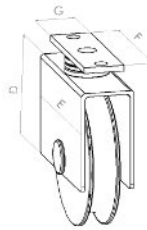
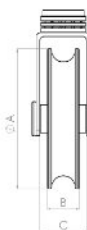

Zincada

## Ferro 5/8" Truck

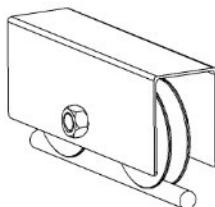

# Roldana U

☉ 1 Rolamento

Cód. Zincada	A	B	C	D	E	Rol.
0915	2.1/2"	18	165	60	50	6201
0916	3"		195	70		6202
0917	4"		235	85		

☉☉ 2 Rolamentos

Cód. Zincada	A	B	C	D	E	Rol.
0918	2.1/2"	24	165	60	50	6201
0919	3"	28	195	70		6202
0920	4"	28	235	85		6203

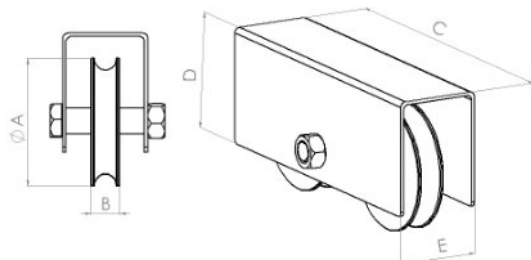

Zincada  
1 Rolamento



Zincada  
2 Rolamentos

# Roldana U

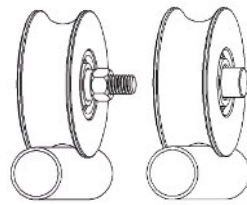

Ferro 3/4"

## Parafuso



Polida



Zincada

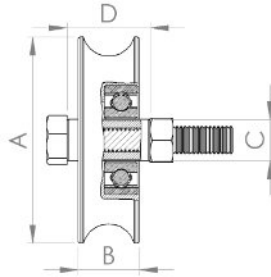

### 1 rolamento

Cód. Polida	Cód. Zincada	A	B	C	D	Rol.	Pa.
0248	0184	1.1/2"	22	12	25	6001	5/16"
0302	0898	2"				6201	
0303	1249	2.1/2"				6202	
0170	1250	70	22	15	25	6202	3/8"
0304	1251	3"					
0305	1252	80					
0361	1253	90					
0306	1254	4"	22	17	25	6203	

### 2 rolamentos

Cód. Polida	Cód. Zincada	A	B	C	D	Rol.	Pa.
1413	1416	1.1/2"	24	12	33	6001	5/16"
0244	1417	2"				6201	
0245	1418	2.1/2"				6202	
1414	1419	70	28	15	33	6202	3/8"
0257	1420	3"					
0258	1421	80					
1415	1422	90					
0259	1423	4"	28	17	33	6203	
0260	1424	5"				6204	M12

## Pino



Polida



Zincada

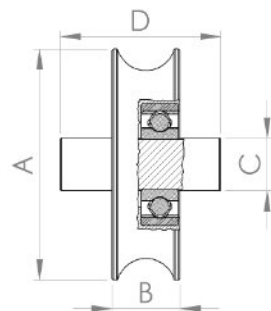

### 1 rolamento

Cód. Polida	Cód. Zincada	A	B	C	D	Rol.
0883	0886	1.1/2"	22	12	45	6001
0307	0887	2"				6201
0308	0888	2.1/2"				6202
0045	0889	70	22	15	45	6202
0023	0890	3"				
0309	0891	80				
0885	0892	90				
0024	0060	4"	22	17	45	6203

### 2 rolamentos

Cód. Polida	Cód. Zincada	A	B	C	D	Rol.
1400	1403	1.1/2"	24	12	60	6001
0261	1404	2"				6201
0262	1405	2.1/2"				6202
1401	1406	70	28	15	60	6202
0052	1407	3"				
0263	1408	80				
1402	1409	90				
0055	1410	4"	28	17	60	6203
0077	1411	5"				6204
0448	1412	6"	32	20	100	6204

**Ferro 3/4"**  
Caixa Fechada

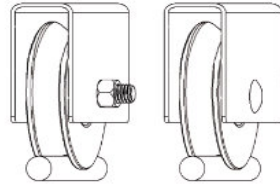

Parafuso

1 rolamento

Cód. Polida	Cód. Zincada	A	B	Rol.	Pa.
1271	1279	1.1/2"	22	6001	5/16"
1272	1280	2"		6201	
1273	1281	2.1/2"		6202	3/8"
1274	1282	70			
1275	1283	3"	28	6202	3/8"
1276	1284	80			
1277	1285	90		6203	
1278	1286	4"			

2 rolamentos

Cód. Polida	Cód. Zincada	A	B	Rol.	Pa.
1441	1449	1.1/2"	24	6001	5/16"
1442	1450	2"		6201	
1443	1451	2.1/2"		28	6202
1444	1452	70			
1445	1453	3"			
1446	1454	80			
1447	1455	90	6203		
1448	1456	4"			

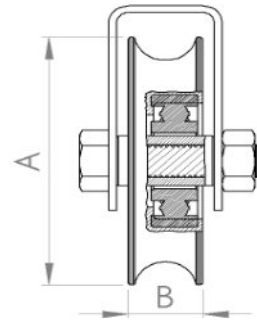

O Rebitada

1 rolamento

Cód. Polida	Cód. Zincada	A	B	Rol.	Rebite
1255	1263	1.1/2"	22	6001	5/16"
1256	1264	2"		6201	
1257	1265	2.1/2"		6202	3/8"
1258	1266	70			
1259	1267	3"	28	6202	3/8"
1260	1268	80			
1261	1269	90		6203	
1262	1270	4"			

2 rolamentos

Cód. Polida	Cód. Zincada	A	B	Rol.	Rebite
1425	1433	1.1/2"	24	6001	5/16"
1426	1434	2"		6201	
1427	1435	2.1/2"		28	6202
1428	1436	70			
1429	1437	3"			
1430	1438	80			
1431	1439	90	6203		
1432	1440	4"			

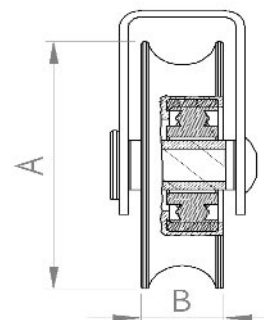

# Roldana U

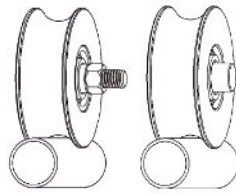

Ferro 7/8"

## Parafuso



Polida



Zincada

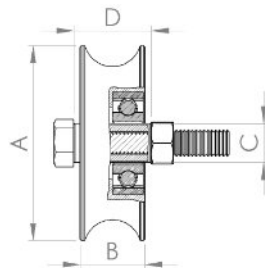

### 1 rolamento

Cód. Polida	Cód. Zincada	A	B	C	D	Rol.	Pa.
0282	1467	2"	25	12	33	6201	5/16"
0283	1468	2.1/2"					
1465	1469	70					
0284	1470	3"	25	15	33	6202	3/8"
0285	1471	80					
1466	1472	90					
0286	1473	4"		17			
						6203	

### 2 rolamentos

Cód. Polida	Cód. Zincada	A	B	C	D	Rol.	Pa.
0250	1515	2"	25	12	33	6201	5/16"
0251	1516	2.1/2"					
1513	1517	70					
0252	1518	3"	28	15	33	6202	3/8"
0253	1519	80					
1514	1520	90					
0254	1521	4"		17			
						6203	
0255	1522	5"	32	20	38	6204	M12

## Pino



Polida



Zincada

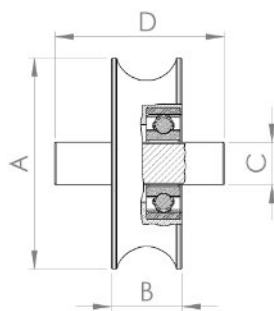

### 1 rolamento

Cód. Polida	Cód. Zincada	A	B	C	D	Rol.
0287	1458	2"	25	12	60	6201
0288	1459	2.1/2"				
0414	1460	70				
0289	1461	3"	25	15	60	6202
0300	1462	80				
1457	1463	90				
0301	1464	4"		17		
						6203

### 2 rolamentos

Cód. Polida	Cód. Zincada	A	B	C	D	Rol.
0246	1504	2"	25	12	60	6201
0249	1505	2.1/2"				
1502	1506	70				
0058	1507	3"	28	15	60	6202
0256	1508	80				
1503	1509	90				
0059	1510	4"		17		
						6203
0078	1511	5"	32	20	100	6204
0449	1512	6"				

**Ferro 7/8"**  
Caixa Fechada

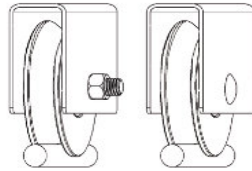

Parafuso

1 rolamento

Cód. polida	Cód. zincada	A	B	Rol.	Pa.
1488	1495	2"	25	6201	5/16"
1489	1496	2.1/2"			
1490	1497	70			
1491	1498	3"	28	6202	3/8"
1492	1499	80			
1493	1500	90			
1494	1501	4"			
				6203	

2 rolamentos

Cód. polida	Cód. zincada	A	B	Rol.	Pa.
1537	1544	2"	25	6201	5/16"
1538	1545	2.1/2"			
1539	1546	70			
1540	1547	3"	28	6202	3/8"
1541	1548	80			
1542	1549	90			
1543	1550	4"			
				6203	

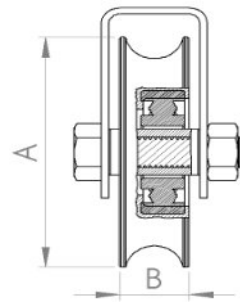

O Rebitada

1 rolamento

Cód. polida	Cód. zincada	A	B	Rol.	Rebite
1474	1481	2"	25	6201	5/16"
1475	1482	2.1/2"			
1476	1483	70			
1477	1484	3"	28	6202	3/8"
1478	1485	80			
1479	1486	90			
1480	1487	4"			
				6203	

2 rolamentos

Cód. polida	Cód. zincada	A	B	Rol.	Rebite
1523	1530	2"	25	6201	5/16"
1524	1531	2.1/2"			
1525	1532	70			
1526	1533	3"	28	6202	3/8"
1527	1534	80			
1528	1535	90			
1529	1536	4"			
				6203	

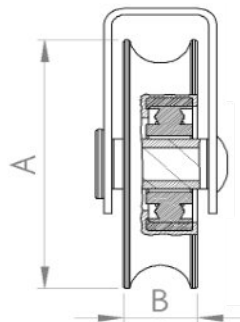

# Roldana U

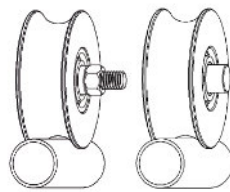

Ferro 1"

## Parafuso



Polida



Zincada

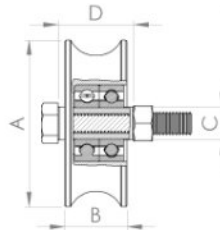

### 2 rolamentos

Cód. polida	Cód. zincada	A	B	C	D	Rol.	Pa.
0238	1564	2"	30	12	35	6201	5/16"
0239	1565	2.1/2"					
1562	1566	70		15			
0240	1567	3"					
0241	1568	80	17	6202	3/8"		
1563	1569	90					
0242	1570	4"					
0243	1571	5"	32	20	38	6204	M12

## Pino



Polida



Zincada

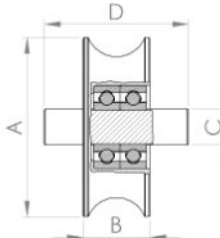

### 2 rolamentos

Cód. polida	Cód. zincada	A	B	C	D	Rol.
0091	1553	2"	30	12	60	6201
0452	1554	2.1/2"				
1551	1555	70		15		
0049	1556	3"				
0247	1557	80	17	6202	3/8"	
1552	1558	90				
0056	1559	4"				
0079	1560	5"	32	20	100	6204
0450	1561	6"				

# Roldana U

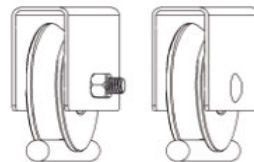

Ferro 1"

Caixa Fechada

## Parafuso



Polida



Zincada

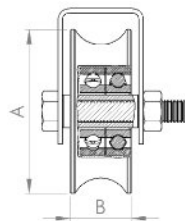

### 2 rolamentos

Cód. polida	Cód. zincada	A	B	Rol.	Parafuso
1586	1593	2"	30	6201	5/16"
1587	1594	2.1/2"			
1588	1595	70		6202	3/8"
1589	1596	3"			
1590	1597	80	17	6203	
1591	1598	90			
1592	1599	4"			

## Rebitada



Polida



Zincada

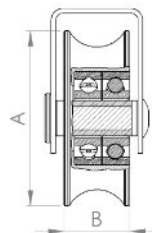

### 2 rolamentos

Cód. polida	Cód. zincada	A	B	Rol.	Rebite
1572	1579	2"	30	6201	5/16"
1573	1580	2.1/2"			
1574	1581	70		6202	3/8"
1575	1582	3"			
1576	1583	80	17	6203	
1577	1584	90			
1578	1585	4"			

# Tube 1/2"

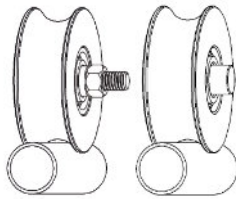

Mais Roldanas

# Roldana U

## Parafuso

### 1 rolamento

Cód. polida	Cód. zincada	A	B	C	D	Rol.	Pa.
1611	1614	2"	25	12	33	6201	5/16"
0389	1615	2.1/2"					
1612	1616	70	25	15	33	6202	3/8"
0402	1617	3"					
0163	1618	80					
1613	1619	90					
0405	1620	4"	25	17	33	6203	3/8"
0406	1621	5"		20			



Polida

### 2 rolamentos

Cód. polida	Cód. zincada	A	B	C	D	Rol.	Pa.
1656	1659	2"	25	12	33	6201	5/16"
0358	1660	2.1/2"					
1657	1661	70	28	15	33	6202	3/8"
0396	1662	3"					
0392	1663	80					
1658	1664	90					
0370	1665	4"	32	17	38	6203	M12
0367	1666	5"		20			

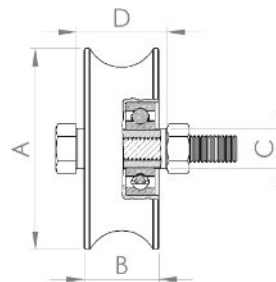

Zincada

### 1 rolamento

Cód.	A	B	C	D	Rol.	Pa.
522	60	28	12	33	6201	5/16"
523	70					
524	3"	28	15	33	6202	3/8"
525	80					
526	90					



Nylon

## Pino

### 1 rolamento

Cód. polida	Cód. zincada	A	B	C	D	Rol.
1600	1603	2"	25	12	60	6201
0373	1604	2.1/2"				
1601	1605	70	25	15	60	6202
0399	1606	3"				
0376	1607	80				
1602	1608	90				
0379	1609	4"	25	17	60	6203
0382	1610	5"		20		



Polida

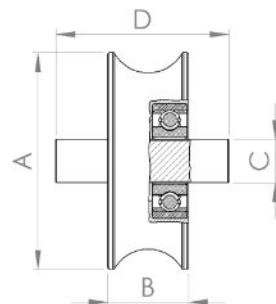

Zincada

### 2 rolamentos

Cód. polida	Cód. zincada	A	B	C	D	Rol.
1645	1648	2"	25	12	60	6201
0298	1649	2.1/2"				
1646	1650	70	28	15	60	6202
0393	1651	3"				
0346	1652	80				
1647	1653	90				
0355	1654	4"	32	17	100	6203
0352	1655	5"		20		

# Roldana U

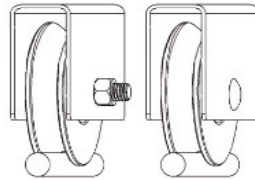

Tube 1/2"

Caixa Fechada

## Parafuso



Polida



Zincada



Nylon

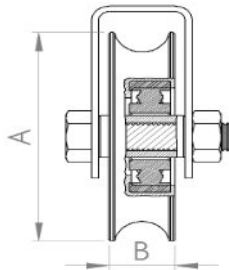

### 1 rolamento

Cód. polida	Cód. zincada	A	B	Rol.	Pa.
0413	1638	2"	25	6201	5/16"
0366	1639	2.1/2"			
1636	1640	70		6202	3/8"
0369	1641	3"			
0372	1642	80			
1637	1643	90			
0375	1644	4"	6203		

### 2 rolamentos

Cód. polida	Cód. zincada	A	B	Rol.	Pa.
1681	1684	2"	25	6201	5/16"
0378	1685	2.1/2"			
1682	1686	70	28	6202	3/8"
0381	1687	3"			
0506	1688	80			
1683	1689	90		6203	
0384	1690	4"			

### 1 Rolamento

Cód.	A	B	Rol.	Parafuso
0685	60	28	6201	5/16"
0686	70			
0687	3"		6202	3/8"
0688	80			
0689	90			

## Pino



Polida



Zincada



Nylon

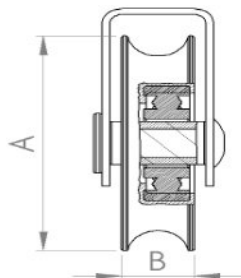

### 1 rolamento

Cód. polida	Cód. zincada	A	B	Rol.	Rebite
1622	1629	2"	25	6201	5/16"
1623	1630	2.1/2"			
1624	1631	70		6202	3/8"
1625	1632	3"			
1626	1633	80			
1627	1634	90			
1628	1635	4"	6203		

### 2 rolamentos

Cód. polida	Cód. zincada	A	B	Rol.	Rebite
1667	1674	2"	25	6201	5/16"
1668	1675	2.1/2"			
1669	1676	70	28	6202	3/8"
1670	1677	3"			
1671	1678	80			
1672	1679	90		6203	
1673	1680	4"			

### 1 Rolamento

Cód.	A	B	Rol.	Rebite
0680	60	28	6201	5/16"
0681	70			
0682	3"		6202	3/8"
0683	80			
0684	90			



Tube 3/4"

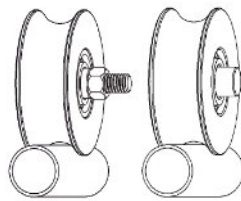

Parafuso

1 rolamento

Cód. polida	Cód. zincada	A	B	C	D	Rol.	Pa.
0390	1702	2.1/2"	28	12		6201	5/16"
1700	1703	70	30	15		33	6202
0403	1704	3"					
0407	1705	80					
1701	1706	90					
0408	1707	4"			17		
0409	1708	5"	32	20	38	6204	M12

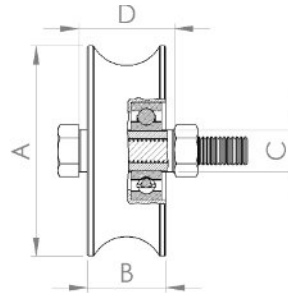

Polida



Zincada

2 rolamentos

Cód. polida	Cód. zincada	A	B	C	D	Rol.	Pa.
0359	1740	2.1/2"	28	12		6201	5/16"
1738	1741	70	30	15		33	6202
0397	1742	3"					
0362	1743	80					
1739	1744	90					
0371	1745	4"			17		
0368	1746	5"	32	20	38	6204	M12

O Rebitada

1 rolamento

Cód. polida	Cód. zincada	A	B	C	D	Rol.
0374	1693	2.1/2"	28	12		6201
1691	1694	70	30	15		60
0400	1695	3"				
0377	1696	80				
1692	1697	90				
0380	1698	4"			17	
0383	1699	5"	32	20	100	6204

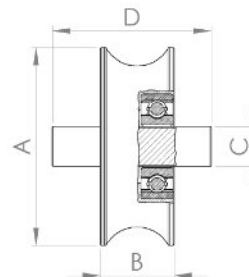

Polida



Zincada

2 rolamentos

Cód. polida	Cód. zincada	A	B	C	D	Rol.
0299	1731	2.1/2"	28	12		6201
1729	1732	70	30	15		60
0394	1733	3"				
0415	1734	80				
1730	1735	90				
0416	1736	4"			17	
0417	1737	5"	32	20	100	6204

# Roldana U

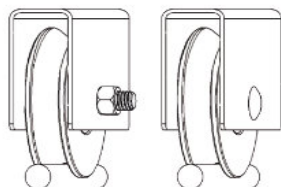

**Tubo 3/4"**

Caixa Fechada

## Parafuso



Polida



Zincada

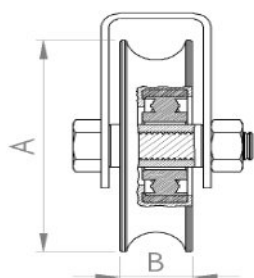

### 1 rolamento

Cód. polida	Cód. zincada	A	B	Rol.	Pa.
0385	1723	2.1/2"	28	6201	5/16"
1721	1724	70	30	6202	3/8"
0386	1725	3"			
0387	1726	80			
1722	1727	90			
0388	1728	4"		6203	

### 2 rolamentos

Cód. polida	Cód. zincada	A	B	Rol.	Pa.
0391	1761	2.1/2"	28	6201	5/16"
1759	1762	70	30	6202	3/8"
0395	1763	3"			
0398	1764	80			
1760	1765	90			
0412	1766	4"		6203	

## Rebitada



Polida



Zincada

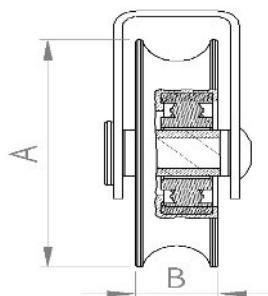

### 1 rolamento

Cód. polida	Cód. zincada	A	B	Rol.	Rebite
1709	1715	2.1/2"	28	6201	5/16"
1710	1716	70	30	6202	3/8"
1711	1717	3"			
1712	1718	80			
1713	1719	90			
1714	1720	4"		6203	

### 2 rolamentos

Cód. polida	Cód. zincada	A	B	Rol.	Rebite
1747	1753	2.1/2"	28	6201	5/16"
1748	1754	70	30	6202	3/8"
1749	1755	3"			
1750	1756	80			
1751	1757	90			
1752	1758	4"		6203	

# Roldana V

 Suporte Encaixado

⊙ 1 rolamento

Cód polida	Cód. zincada	A	B	Rol.
0453	1767	2"	16	6201
0454	1768	2.1/2"		
0458	1769	70		
0455	1770	3"	16	6202
0459	1771	80		
0460	1772	90		
0456	1773	4"		

⊙⊙ 2 rolamentos

Cód polida	Cód. zincada	A	B	Rol.
0462	1774	2"	24	6201
0463	1775	2.1/2"		
0467	1776	70	28	6202
0464	1777	3"		
0468	1778	80		
0469	1779	90		
0465	1780	4"		

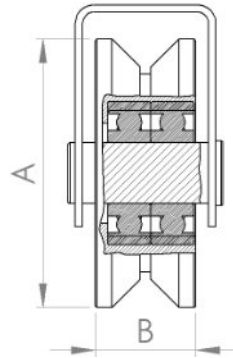

Polida



Zincada

# Tubo 1/2"

 Suporte Encaixado

# Roldana U

⊙ 1 rolamento

Cód polida	Cód. zincada	A	B	Rol.
0471	1781	2"	25	6201
0472	1782	2.1/2"		
0476	1783	70		
0473	1784	3"	25	6202
0477	1785	80		
0478	1786	90		
0474	1787	4"		

⊙⊙ 2 rolamentos

Cód polida	Cód. zincada	A	B	Rol.
0480	1788	2"	25	6201
0481	1789	2.1/2"		
0485	1790	70	28	6202
0482	1791	3"		
0486	1792	80		
0487	1793	90		
0483	1794	4"		

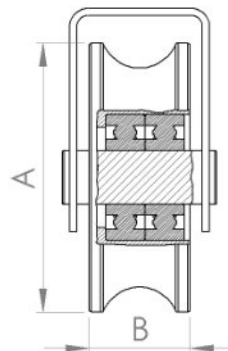

Polida



Zincada

# Roldana U

## Tube 3/4"

 Suporte Encaixado



Polida



Zincada

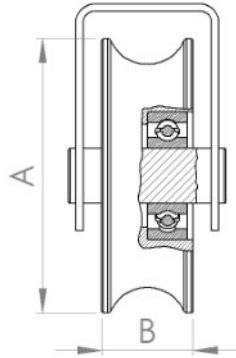

### 1 rolamento

Cód. polida	Cód. zincada	A	B	Rol.
0489	1795	2"	30	6201
0490	1796	2.1/2"		
0494	1797	70		6202
0491	1798	3"		
0495	1799	80		
0496	1800	90		
0492	1801	4"	6203	

### 2 rolamentos

Cód. polida	Cód. zincada	A	B	Rol.
0498	1802	2"	30	6201
0499	1803	2.1/2"		
0503	1804	70		6202
0500	1805	3"		
0504	1806	80		
0505	1807	90		
0501	1808	4"	6203	

# Roldana Lisa

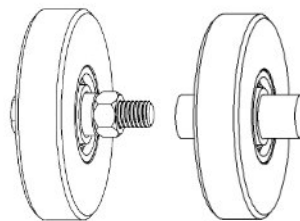

## Parafuso



Polida



Zincada

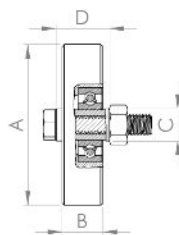

### 1 rolamento

Cód. polida	Cód. zincada	A	B	C	D	Rol.	Pa.
0423	0427	2"	17	12	25	6201	5/16"
0424	0428	2.1/2"	19				
0425	0429	3"		15		6202	3/8"
0426	0430	4"					

## Pino



Polida



Zincada

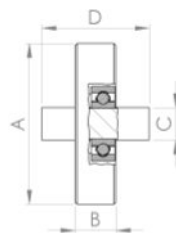

### 1 rolamento

Cód. polida	Cód. zincada	A	B	C	D	Rol.
1175	1179	2"	17	12	45	6201
1176	1180	2.1/2"	19			
1177	1181	3"		15		6202
1178	1182	4"				

10x10

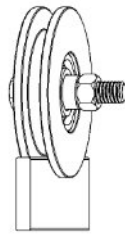

# Roldana Cava Quadrada

Parafuso

1 rolamento

Cód. polida	Cód. zincada	A	B	C	D	Rol.	Pa.
0080	1195	2"	16	12	25	6001	5/16"
0081	1196	2.1/2"				6201	
1184	1197	70	16	15	25	6202	3/8"
0082	1198	3"					
0083	1199	80					
0084	1200	90					
0085	1201	4"					
0086	1202	5"					

2 rolamentos

Cód. polida	Cód. zincada	A	B	C	D	Rol.	Pa.		
0631	1211	2"	24	12	33	6201	5/16"		
0632	1212	2.1/2"							
1186	1213	70	28	15	33	6202	3/8"		
0633	1214	3"							
0634	1215	80							
0635	1216	90							
0636	1217	4"						17	6203
0637	1218	5"						32	20

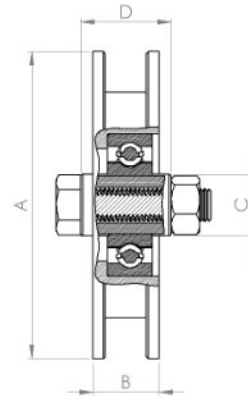

Polida



Zincada

Pino

1 rolamento

Cód. polida	Cód. zincada	A	B	C	D	Rol.
0444	1187	2"	16	12	45	6001
0433	1188	2.1/2"				6201
1183	1189	70	16	15	45	6202
0434	1190	3"				
0435	1191	80				
0436	1192	90				
0437	1193	4"				
0438	1194	5"				

2 rolamentos

Cód. polida	Cód. zincada	A	B	C	D	Rol.		
0624	1203	2"	24	12	60	6001		
0625	1204	2.1/2"				6201		
1185	1205	70	28	15	60	6202		
0626	1206	3"						
0627	1207	80						
0628	1208	90						
0629	1209	4"					17	6203
0630	1210	5"					32	20

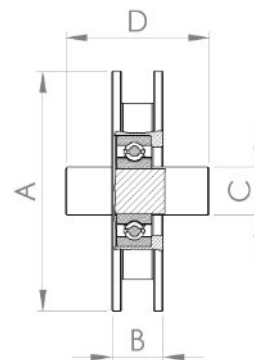

Polida



Zincada

 Eixo  Parafuso



Nylon Preto

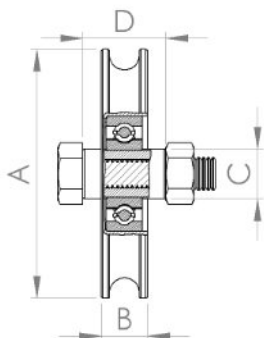

⊙ 1 rolamento

Cód.	A	B	C	D	Pa.	Rol.
0904	3"	20	17	28,5	3/8"	6203
0902	4"					

 Eixo + Canal para Chaveta



Nylon Preto

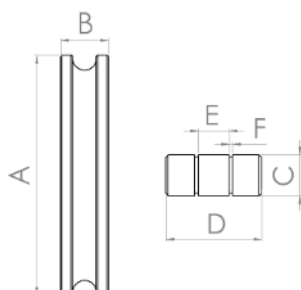

⊙ 1 rolamento

Cód.	A	B	C	D	E	F	Rol.
0905	3"	20	17	40	12,8	1,5	6203
0903	4"						

Para Varal  
O Rebitada

Roldana U

1 rolamento + suporte

Cód.	A	B	C	D	E	F	Rebite	Rol.
0996	2.1/2"			80		70	5/16"	6201
0997	3"	20	29	95	2	83	3/8"	6202
0998	4"			120		105		

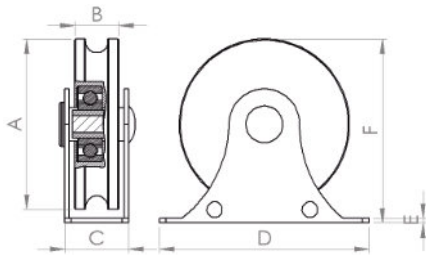

Nylon

Porta de Correr  
Trilho UAL

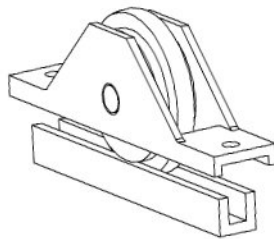

Roldana

1 rolamento

Cód.	A	B	C	D	E	F
0461	48	38	5.8	12.2	21	110

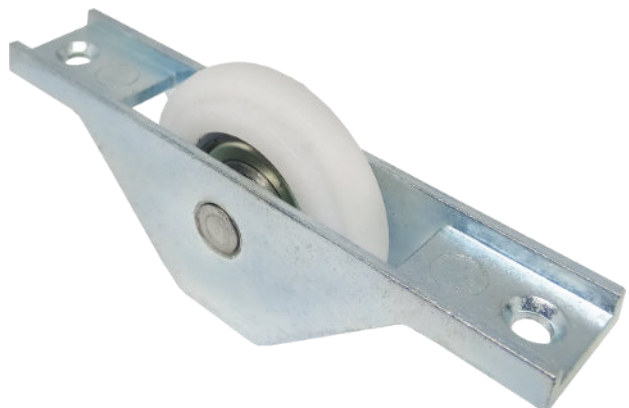
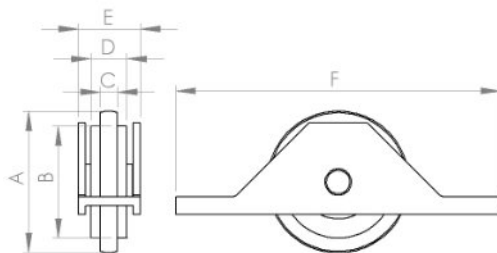



## VENDAS

☎ (54) 3441 7475

✉ [comercial@polettometalurgica.com.br](mailto:comercial@polettometalurgica.com.br)

## ORÇAMENTO ONLINE

[www.polettometalurgica.com.br](http://www.polettometalurgica.com.br)